

**OKI**

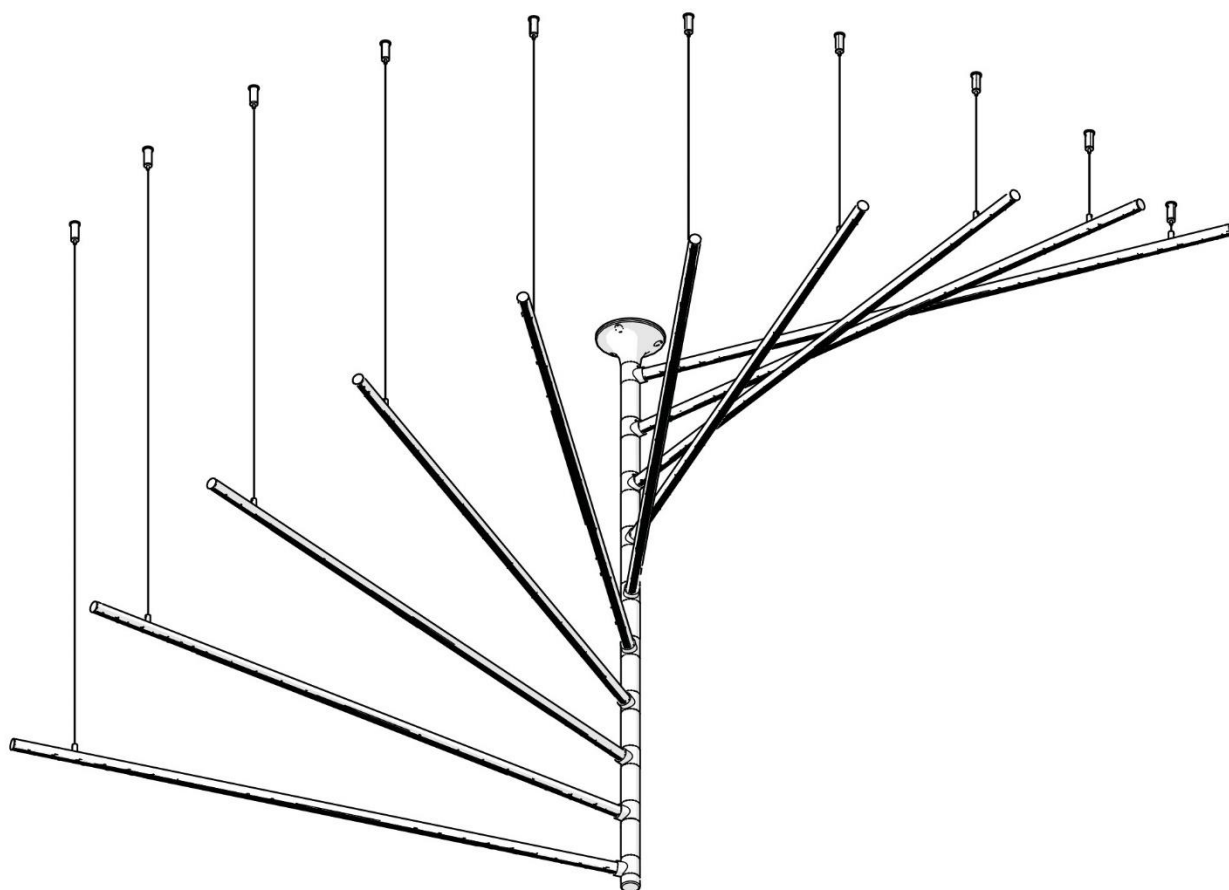

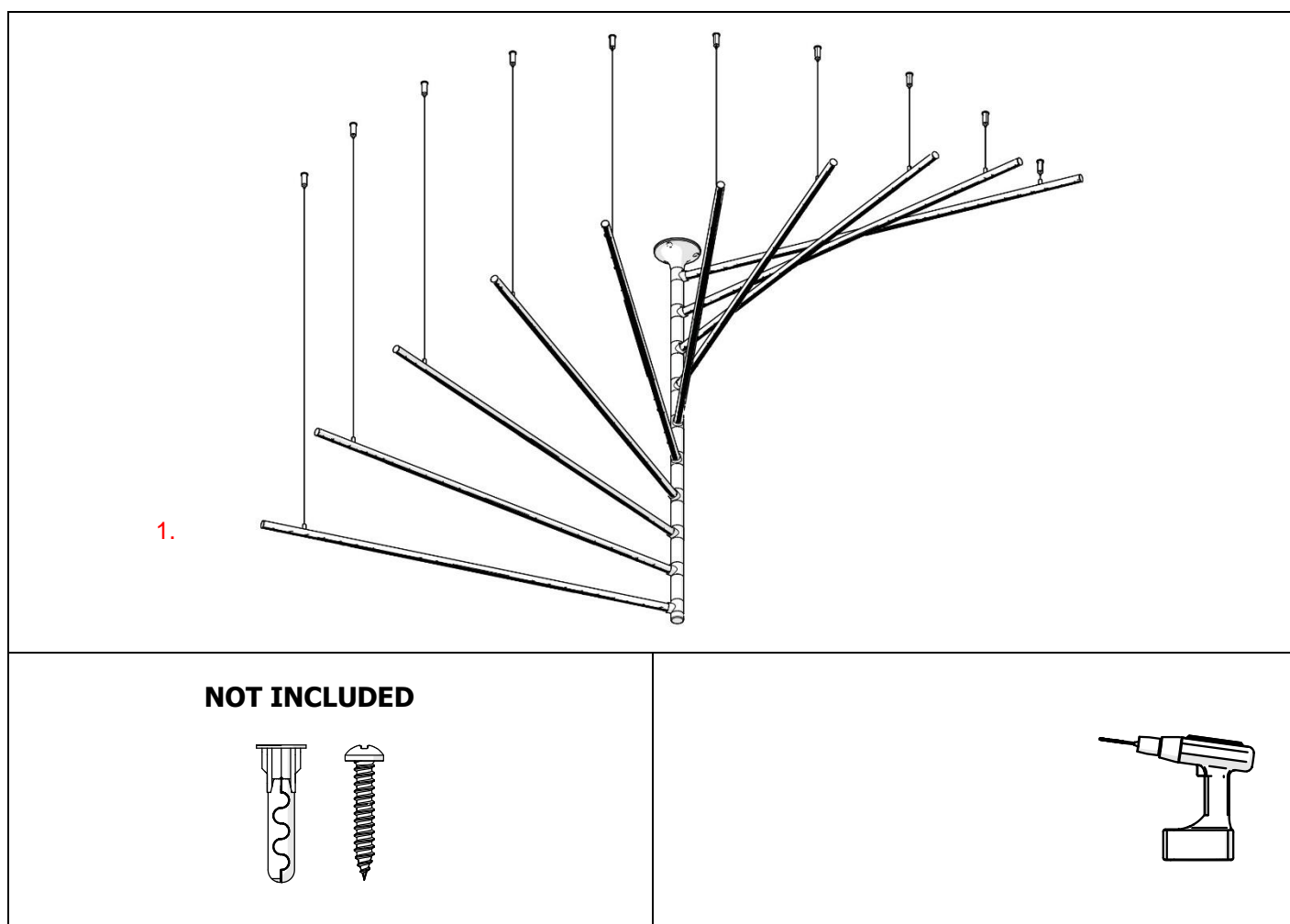

1. OKI Fixture\*

\*The full range of accessories and electronics is available at [www.KlusDesign.eu](http://www.KlusDesign.eu)

**NOTE!** Screws and mounting dowels should be selected according to the type of surface.

**IMPORTANT:** Not all possible mounting procedures are presented here. More mounting procedures and related accessories can be found at [www.KlusDesign.eu](http://www.KlusDesign.eu). Drawings in these instructions are simplified and only approximate the actual shapes.

I

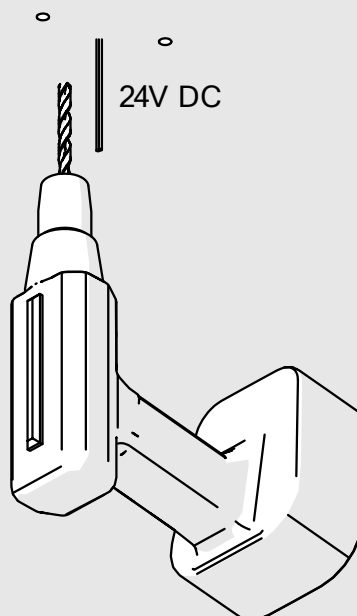

II

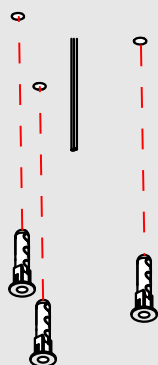
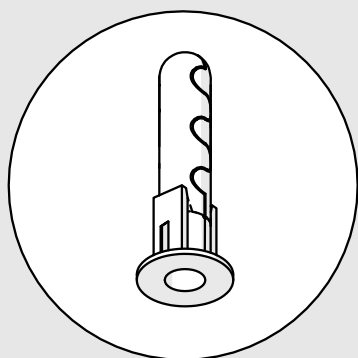

**III**

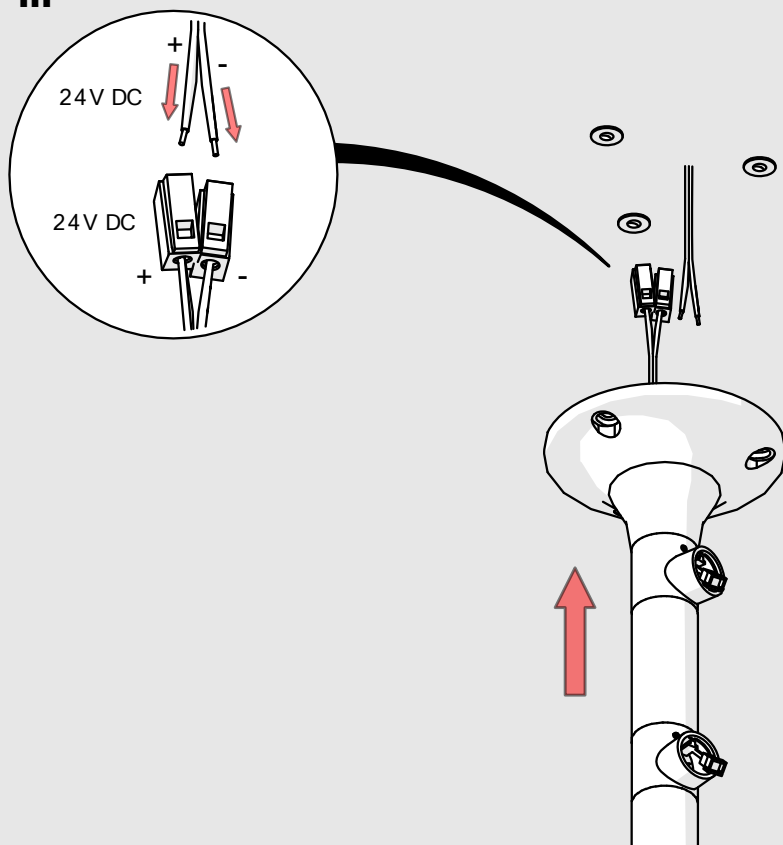

**IV**

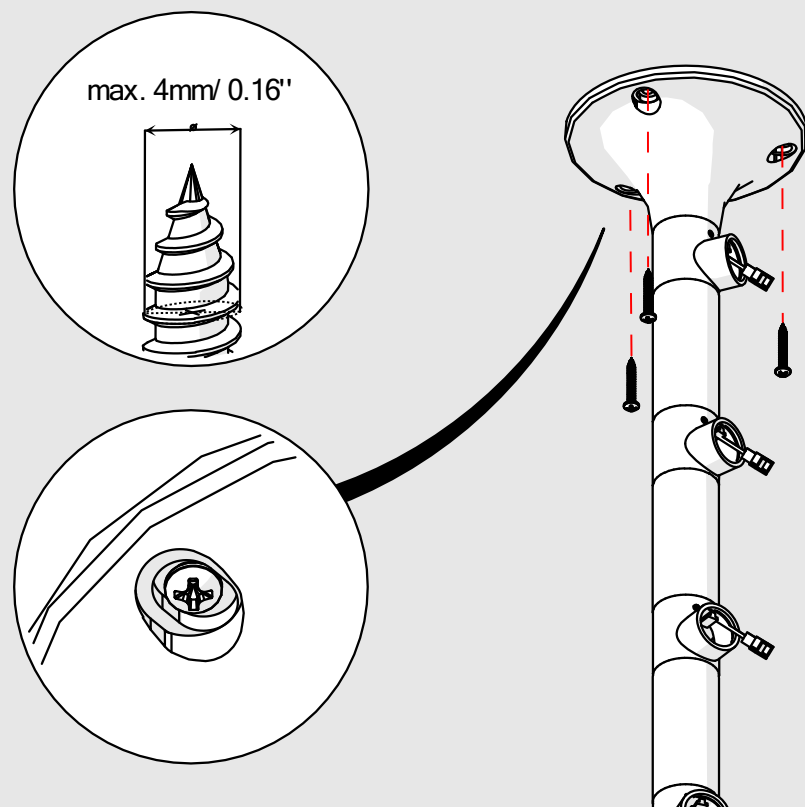

**V**

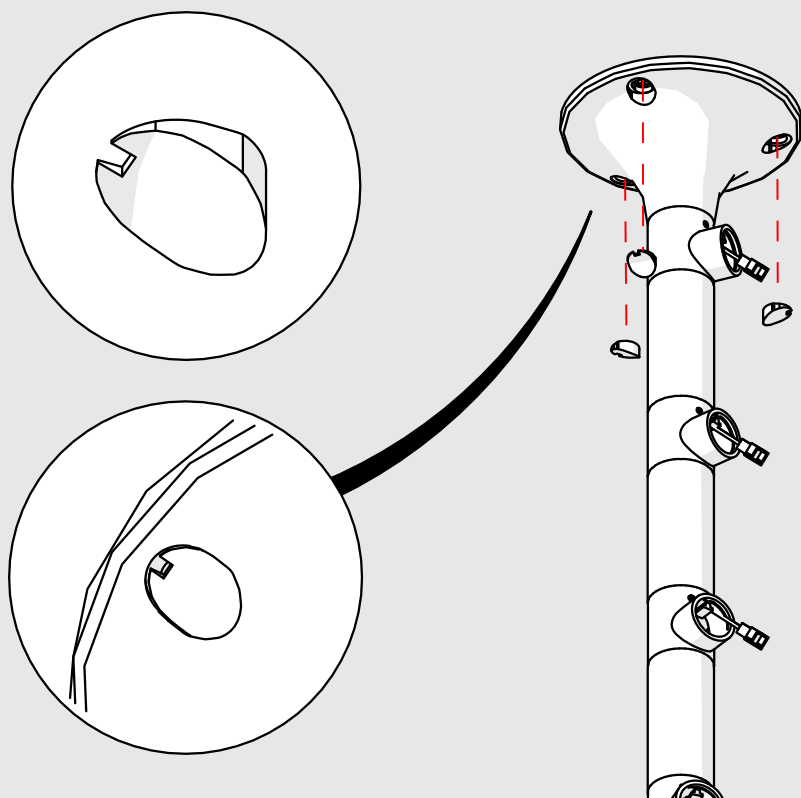

**VI**

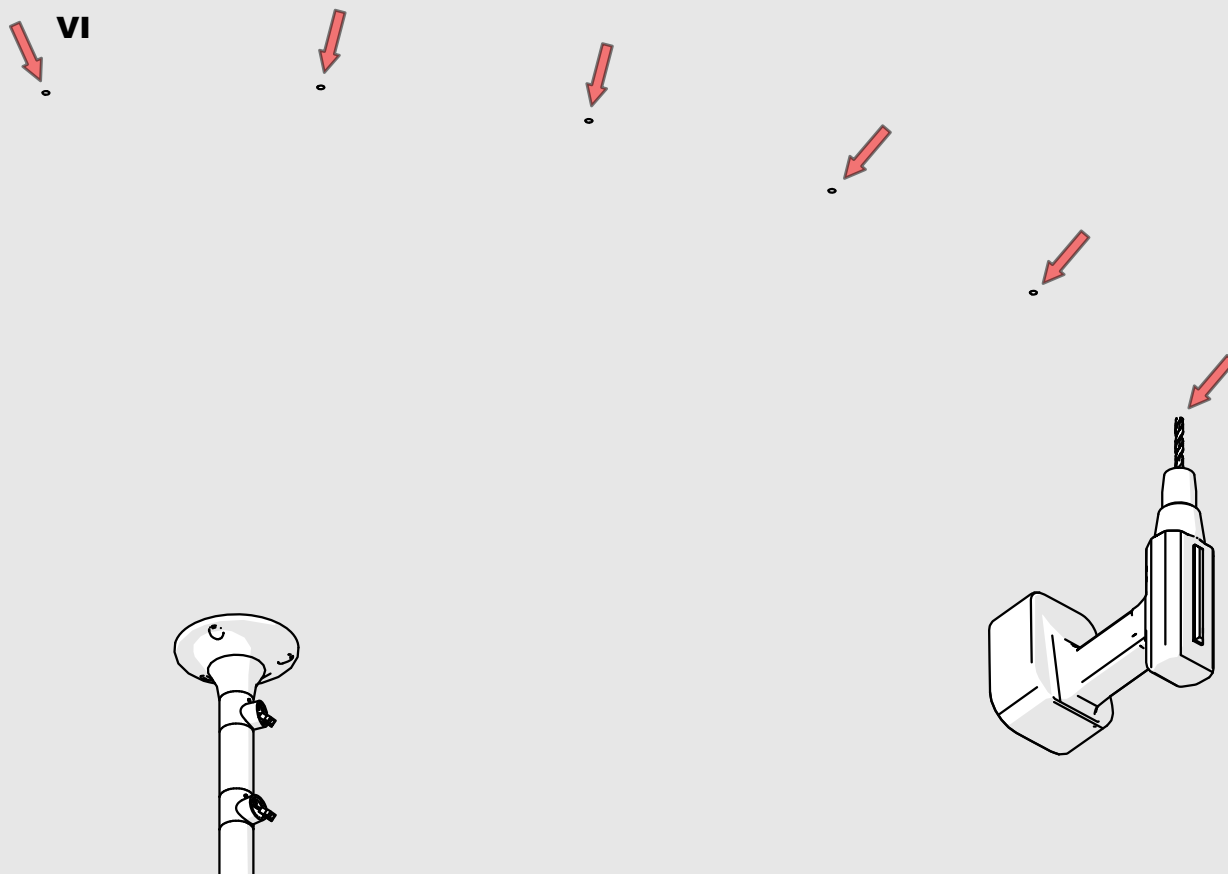

**VII**

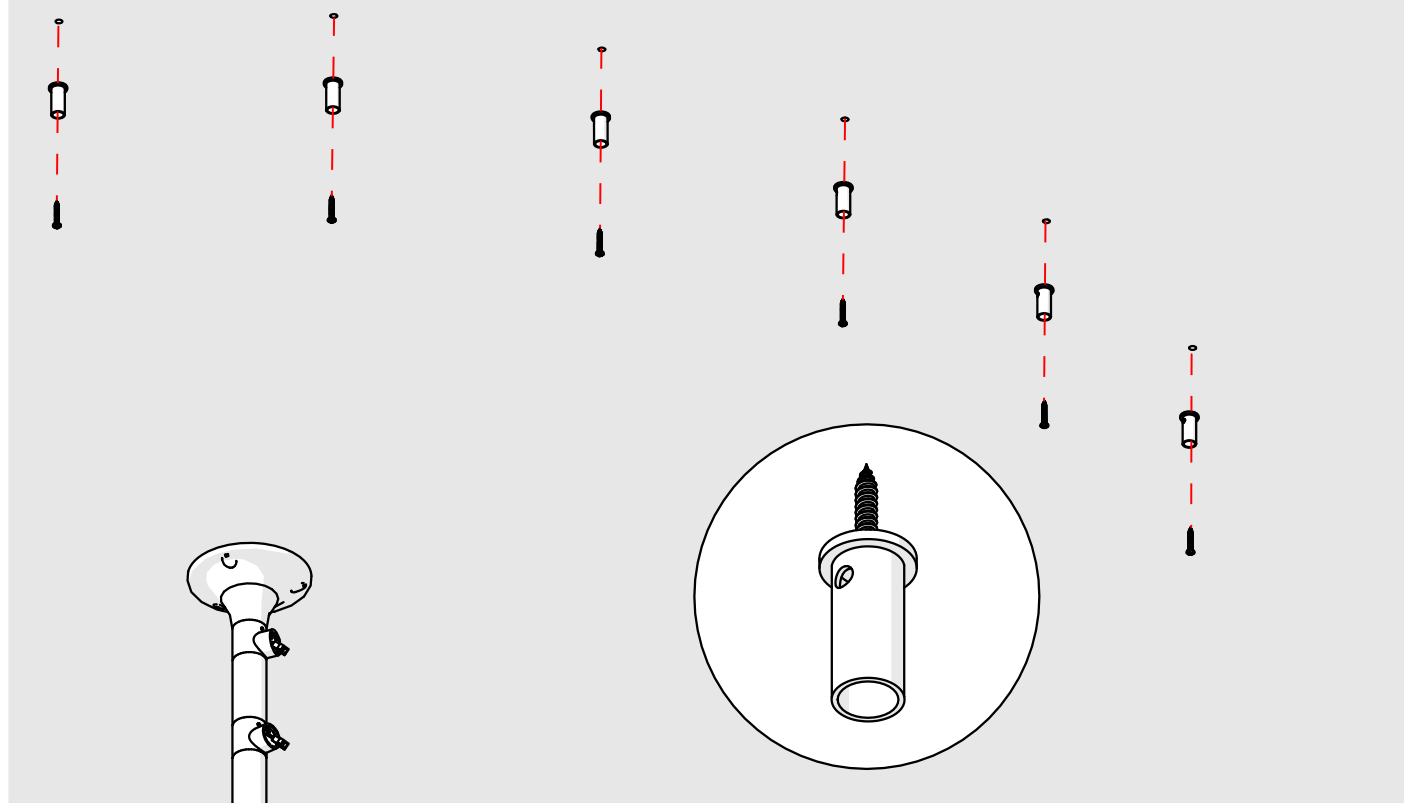

**VIII**

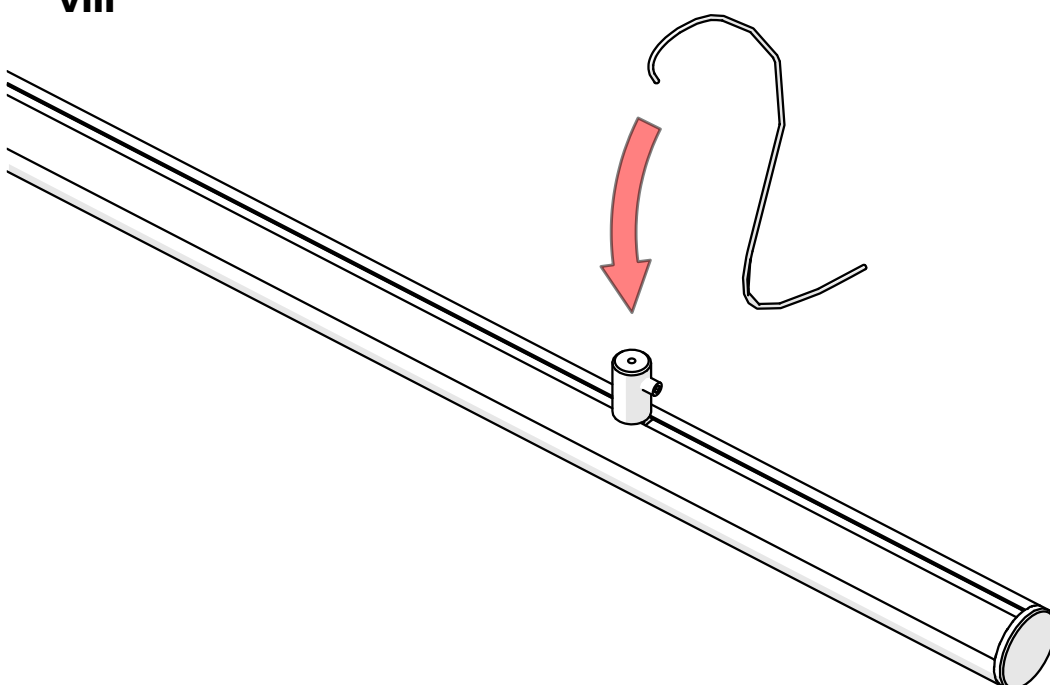

**IX**

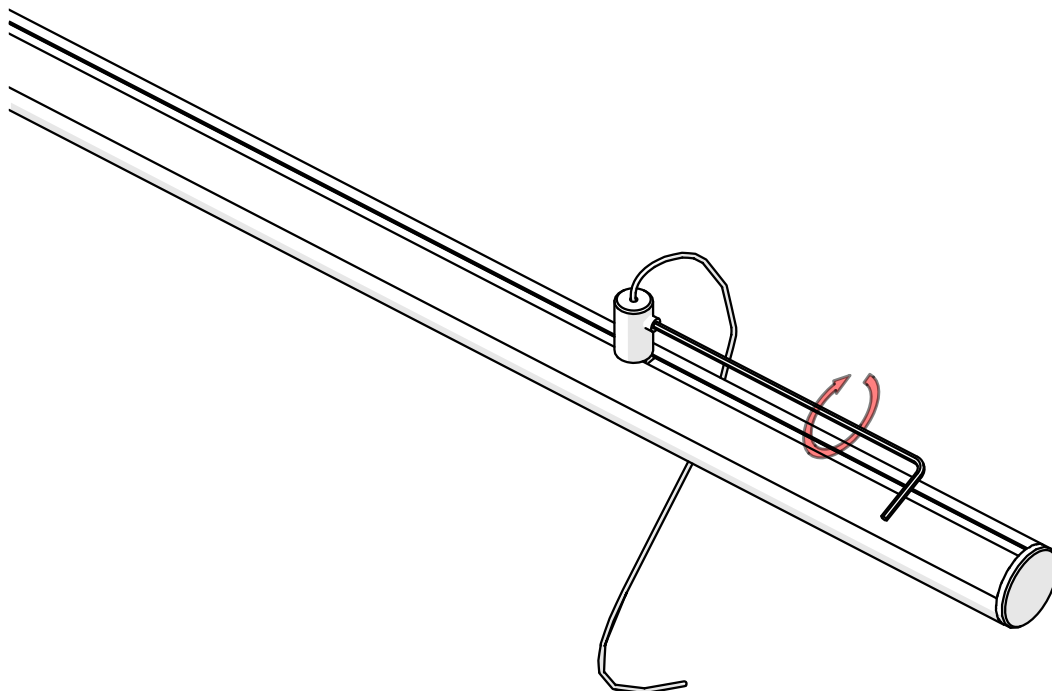

**X**

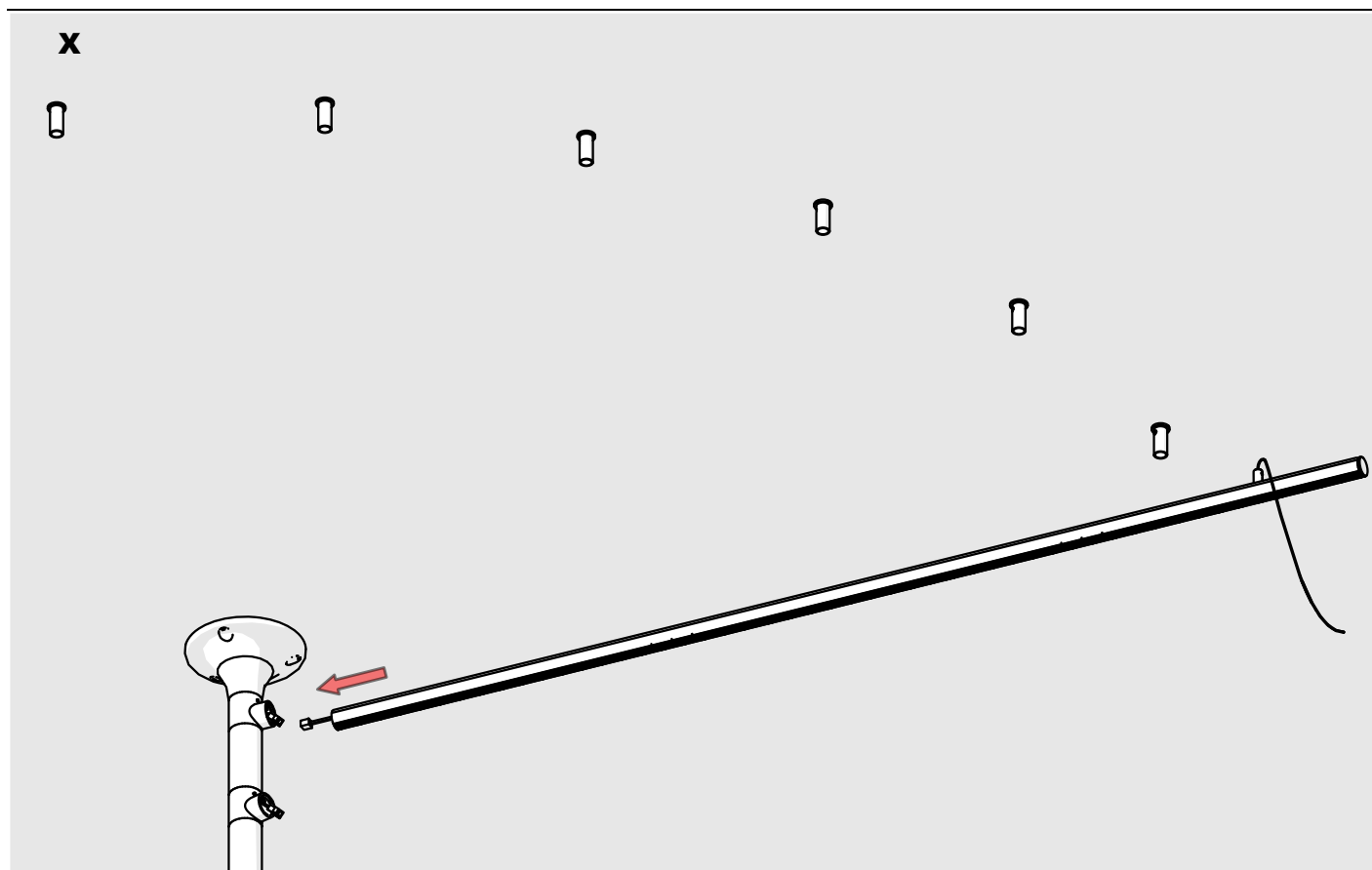

**XI**

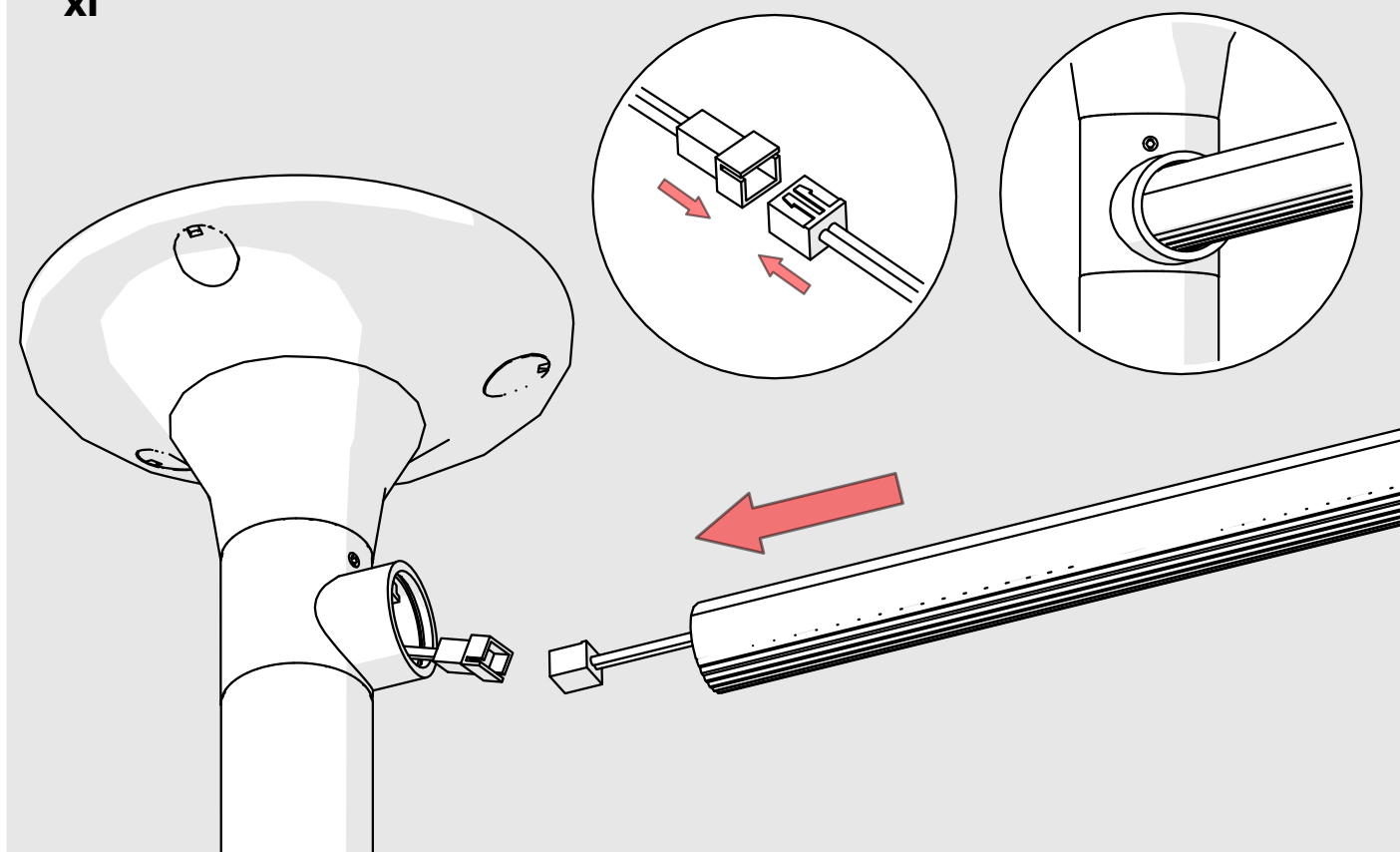

**XII**

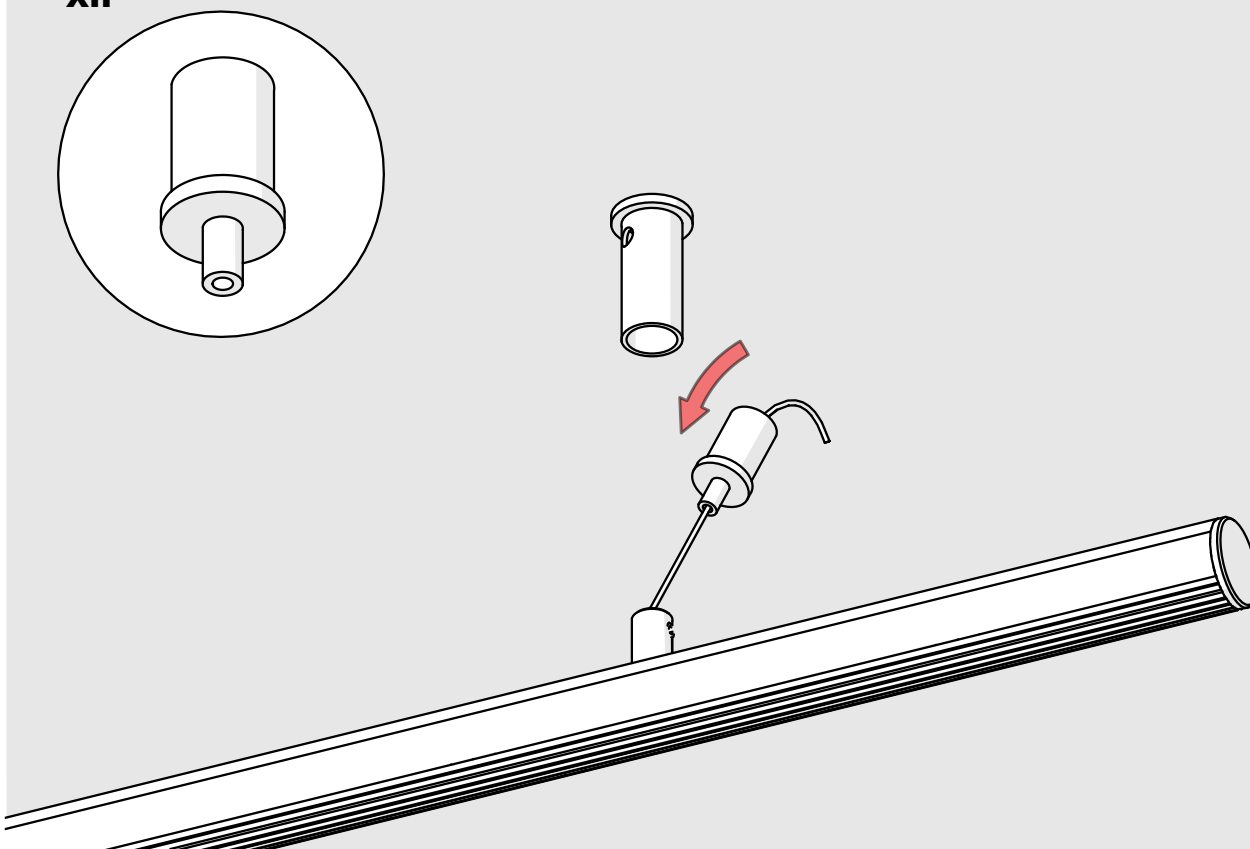

**XIII**

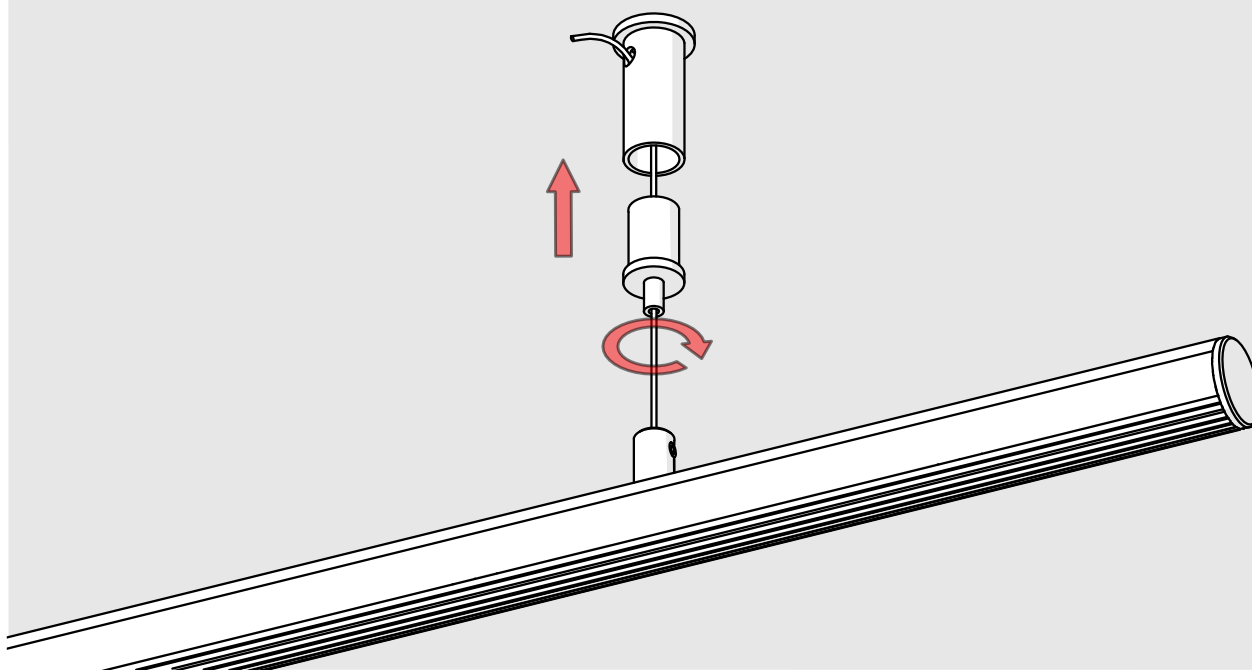

**XIV**

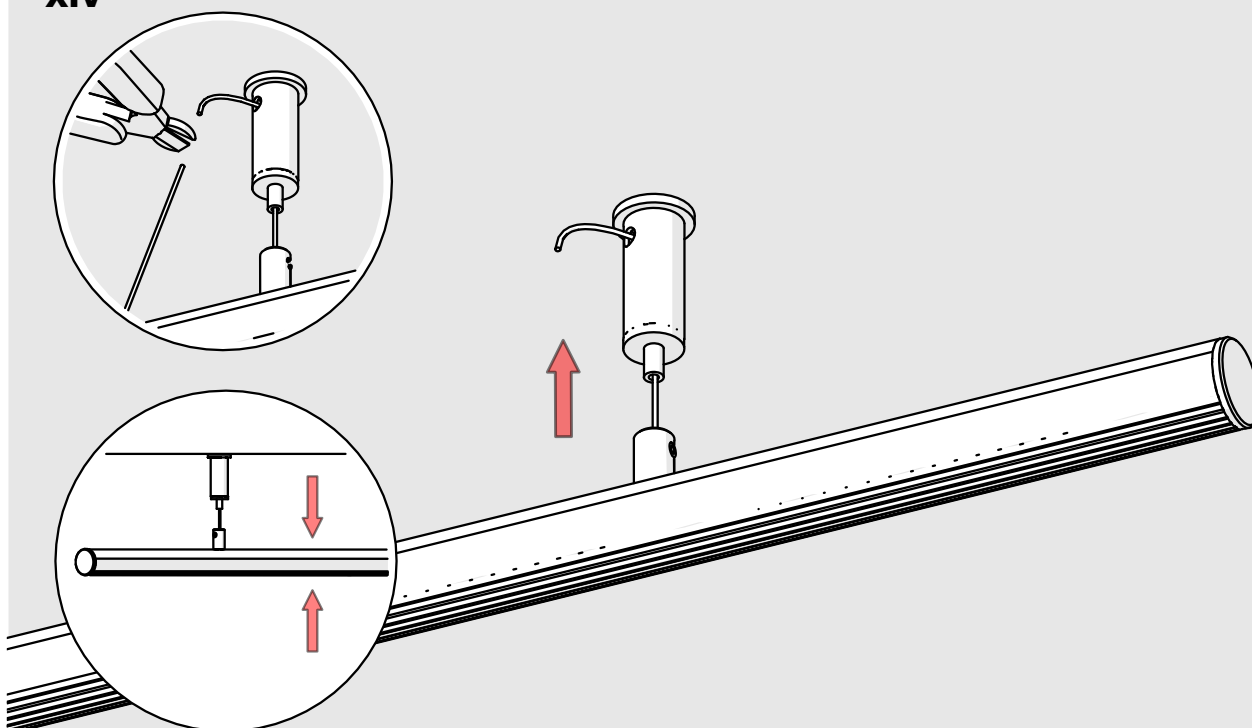

**XV**

