

## Base for suspensions

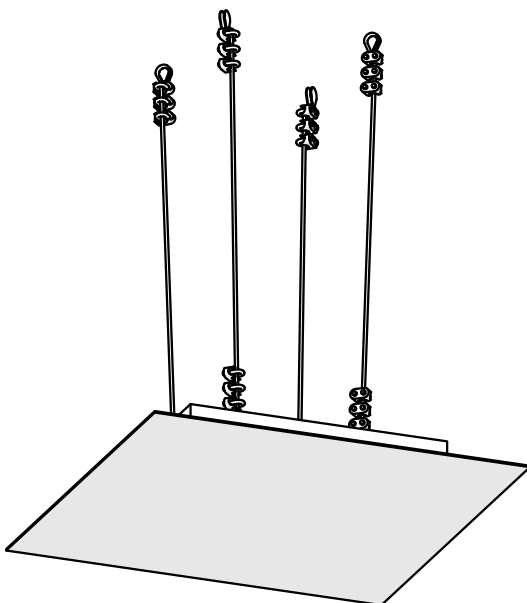

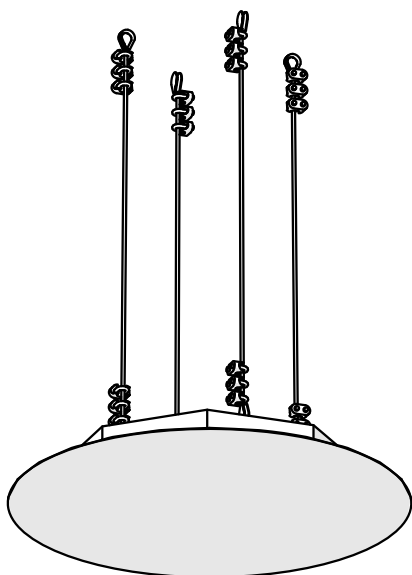
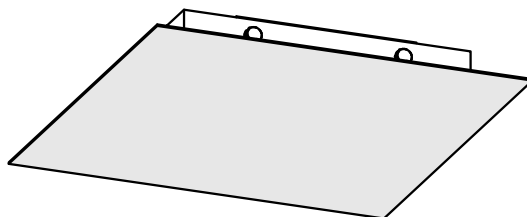
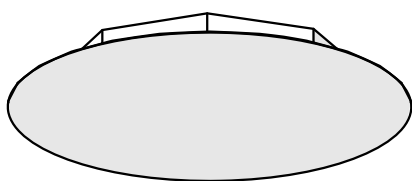
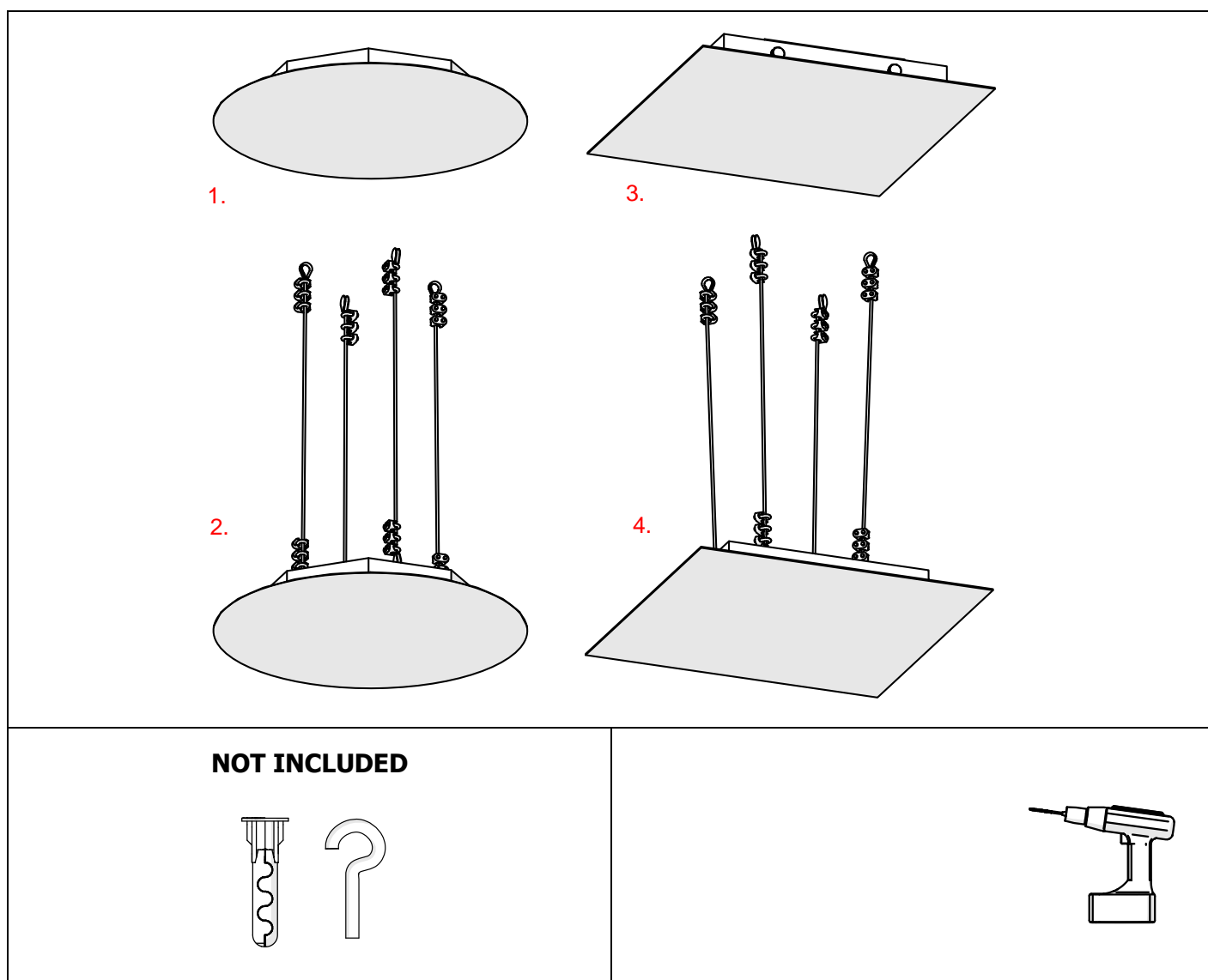

1. Base for suspensions FI surface mounted\*
2. Base for suspensions FI\*
3. Base for suspensions SQ surface mounted\*
4. Base for suspensions SQ\*

\*The full range of accessories and electronics is available at [www.KlusDesign.eu](http://www.KlusDesign.eu)

**NOTE!** Screws and mounting dowels should be selected according to the type of surface.

**IMPORTANT:** Not all possible mounting procedures are presented here. More mounting procedures and related accessories can be found at [www.KlusDesign.eu](http://www.KlusDesign.eu). Drawings in these instructions are simplified and only approximate the actual shapes.

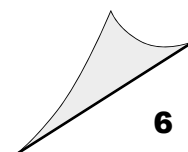
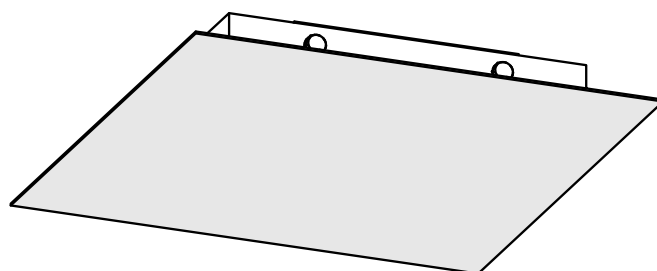
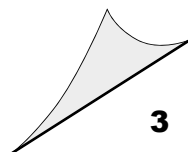
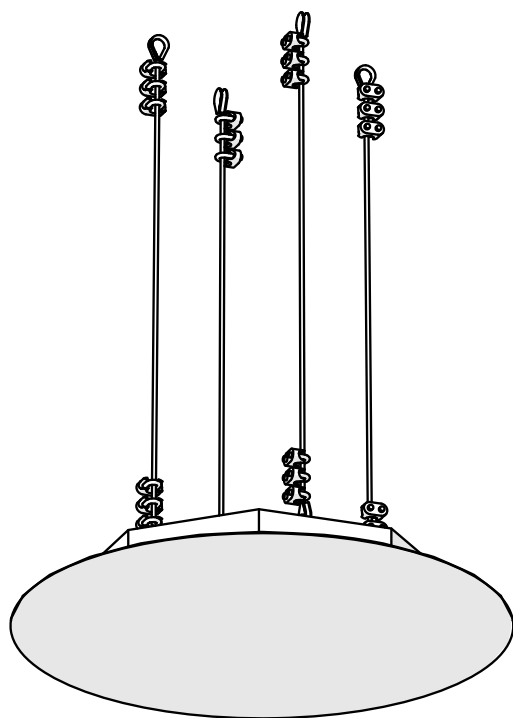

**Ia**

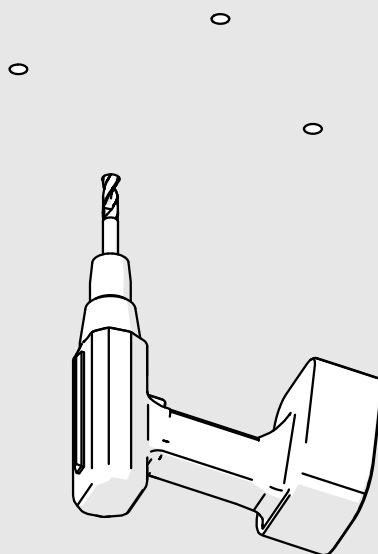

**Ila**

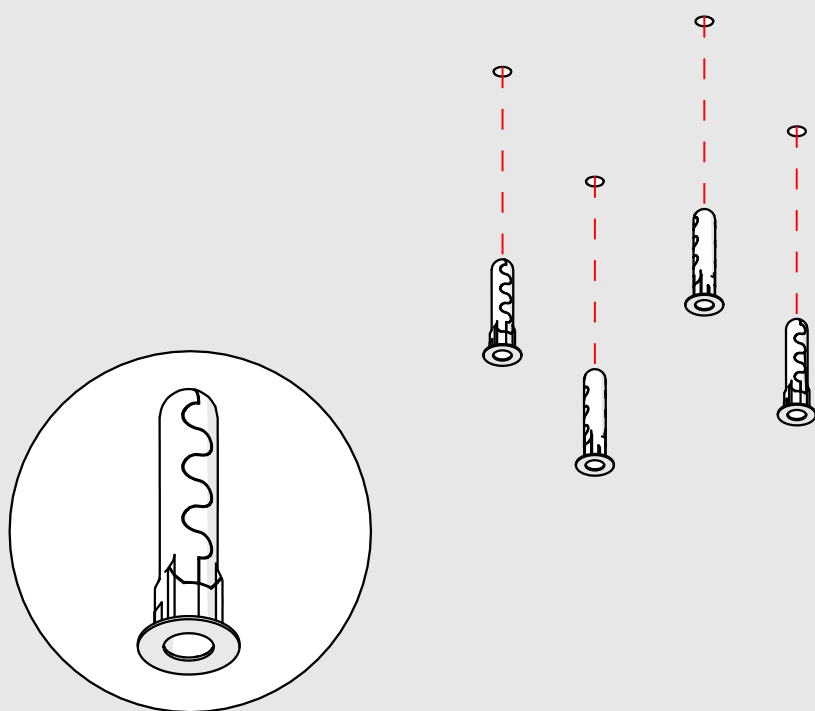

**IIIa**

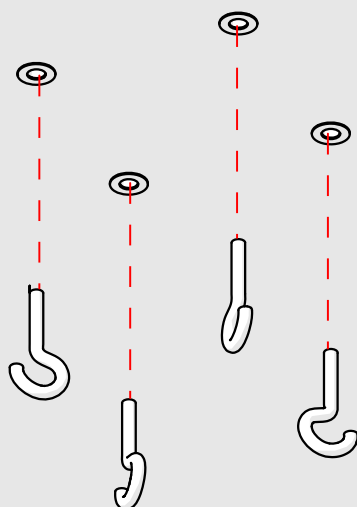
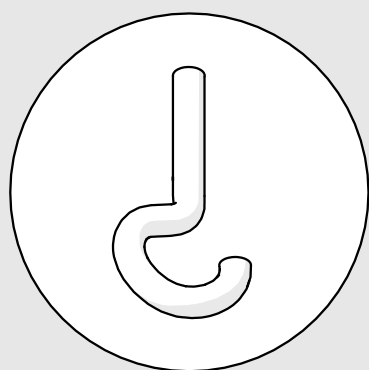

**IVa**

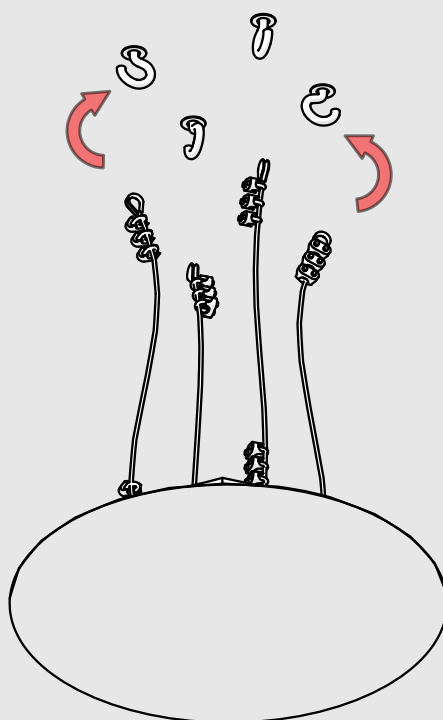
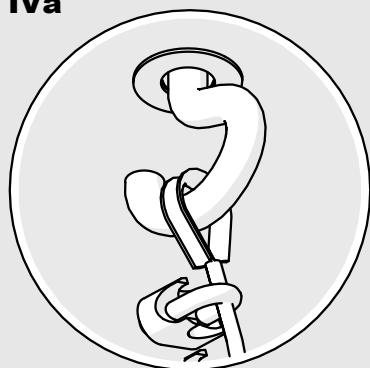

**Va**

MAX. 150 kg

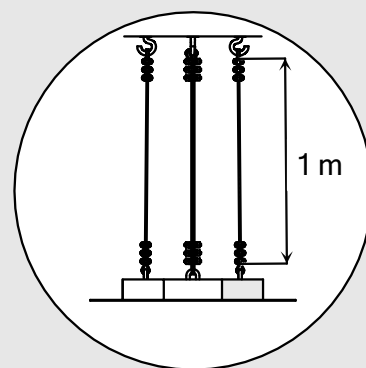
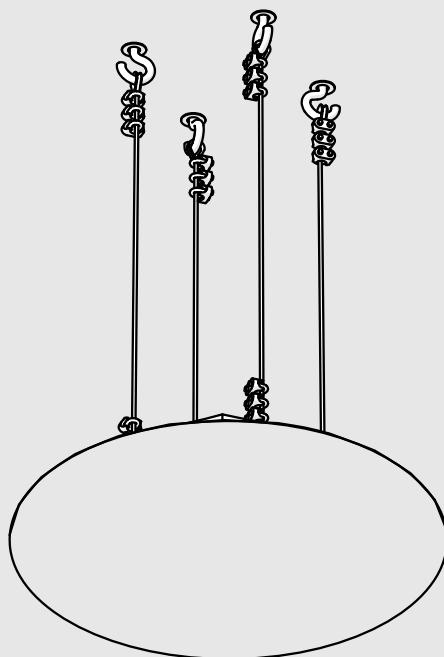

**Ib**

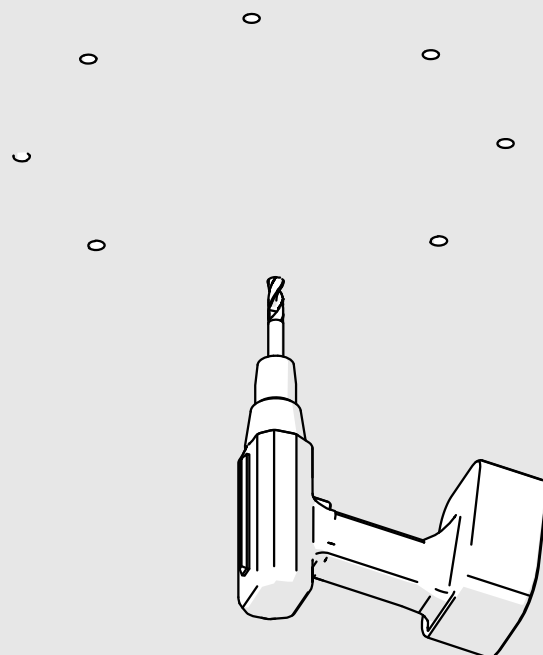

**IIb**

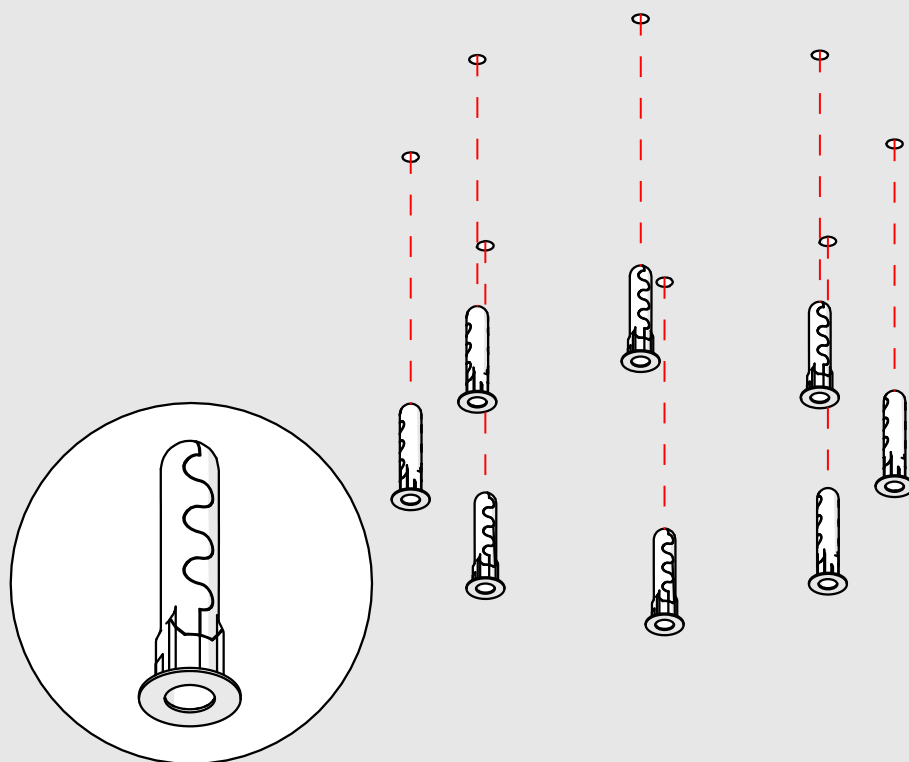

**IIIb**

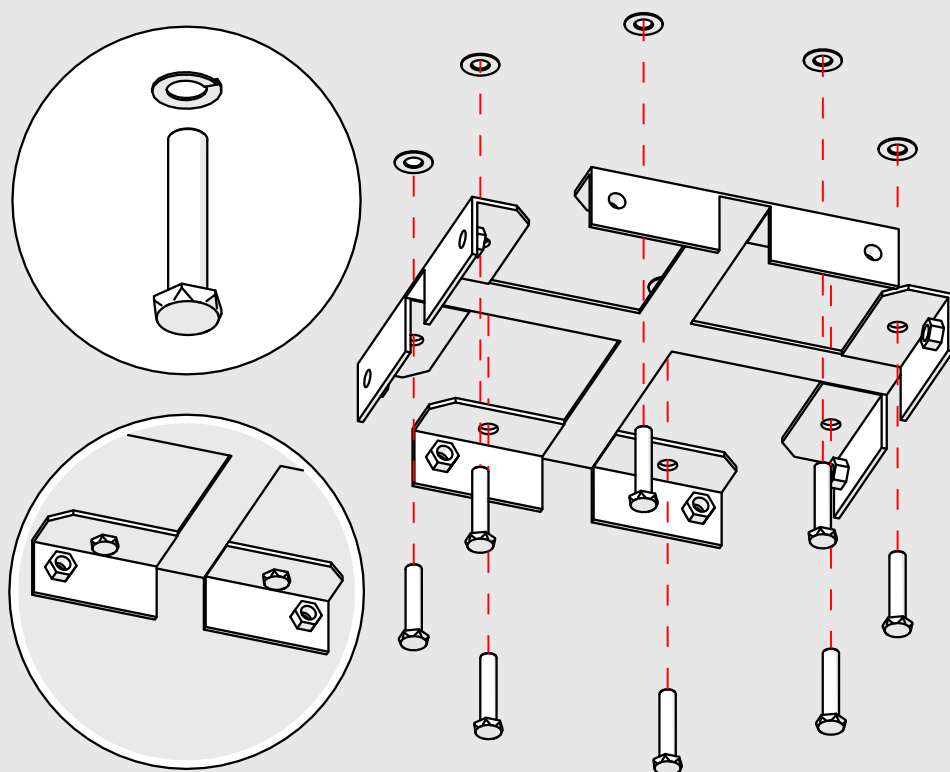

**IVb**

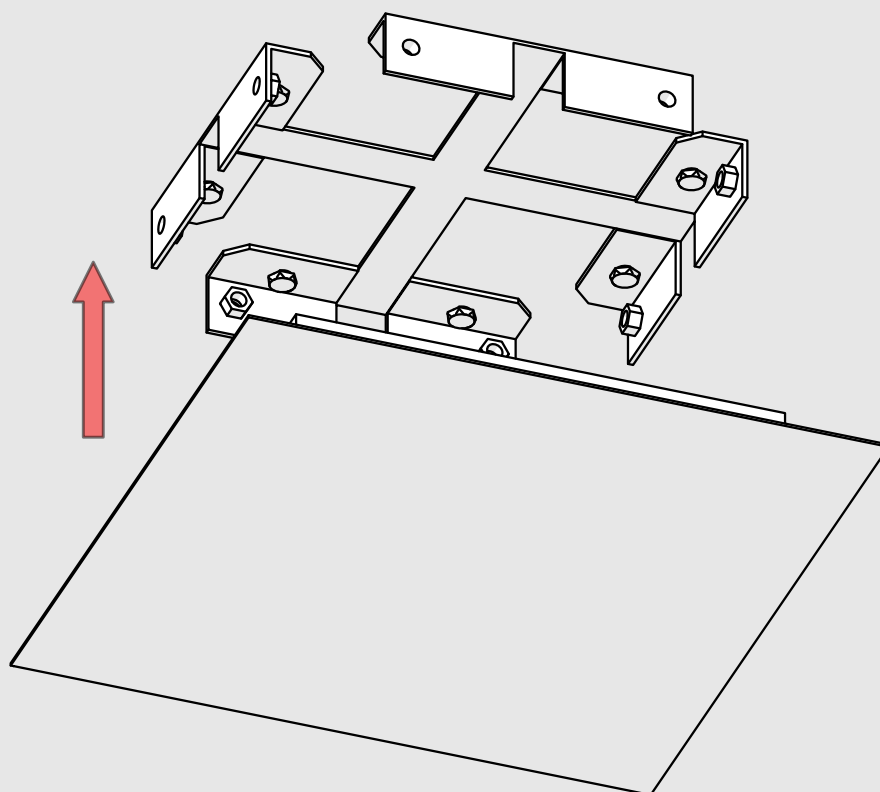



**Vb**

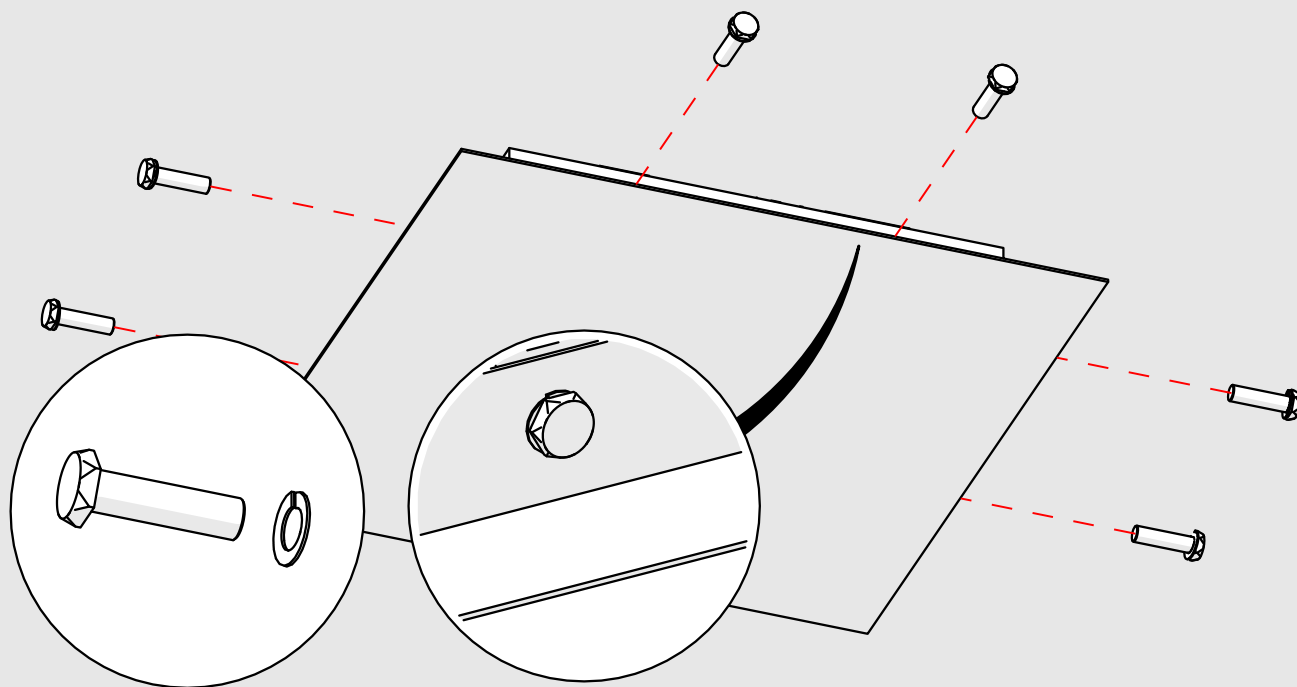

**VIb**

