

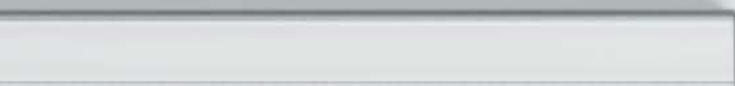

SERPENT-PLUS

**Innovative, configurable
lighting system**





KLUS - a company with a long tradition, whose core activity has always been DESIGN, perceived as conscious design in which the function and quality of the product form a harmonious whole. We are distinguished by the flexibility of the forms offered, modularity and systemicity, which allows architects, investors and individual customers to design and select LED lighting solutions tailored to their needs.



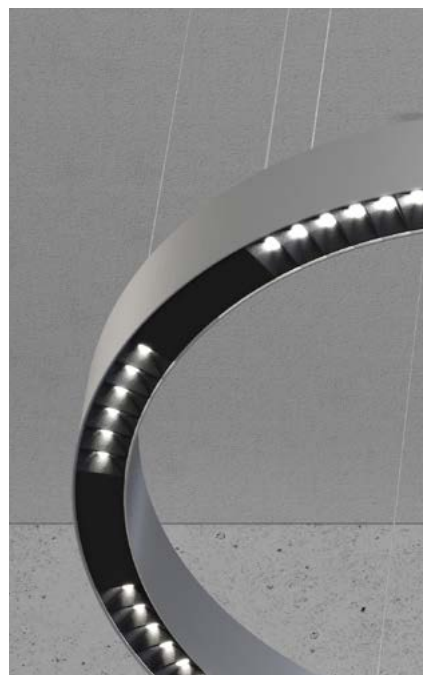

Flexible forms and LED performance in a single system

SERPENT-PLUS is a new generation of linear LED luminaires by KLUŚ, created for modern architecture and interior design. It offers full design freedom - from straight lines to complex geometric structures. It combines form flexibility, energy efficiency and easier installation. Innovations include magnetic connectors, a silicone uplight cover, an improved reflector and advanced customisation options.

The system is ideal for elegant offices, galleries, hotels, restaurants and commercial and exhibition spaces, offering a combination of superior quality, functionality and aesthetics.

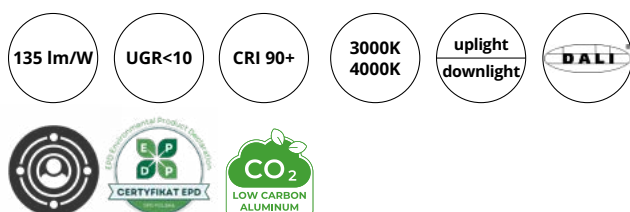



For offices
and commercial spaces

Visual comfort and productivity

Low UGR reduces visual fatigue and
increases productivity.

High luminous efficacy

Efficiency of up to 135 lm/W, from the
finished luminaire, ensures low energy
consumption and running costs.

Uplight/Downlight function

Flexible lighting modelling, from intense
work light to a subtle background.

Precise light control

The different types of optics available
(milky, micro-prismatic, DOT-45 lenticular),
allow for precise light direction.

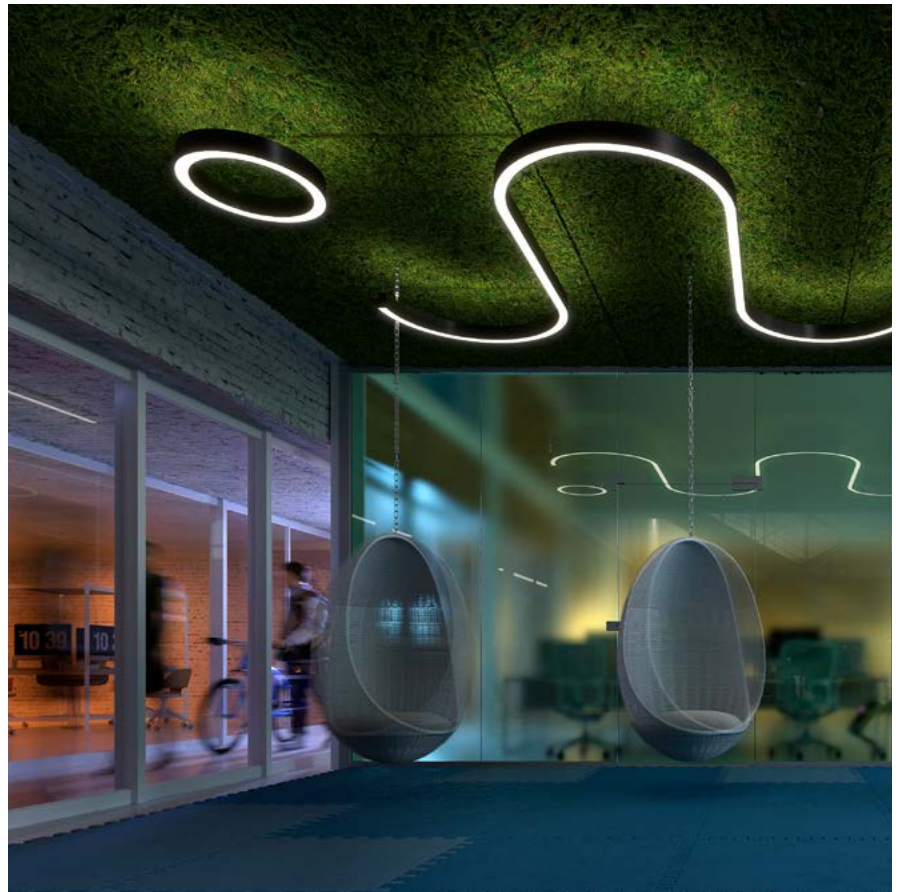



For galleries, hotels and restaurants

Complete design freedom

From simple lines to complex geometric compositions.

Creating atmospheres and lighting scenes

DALI control allows flexible shaping of lighting scenes.

High light quality

LED modules ensure uniform light emission with high colour consistency (CRI ≥ 90), which is crucial for faithful colour reproduction.

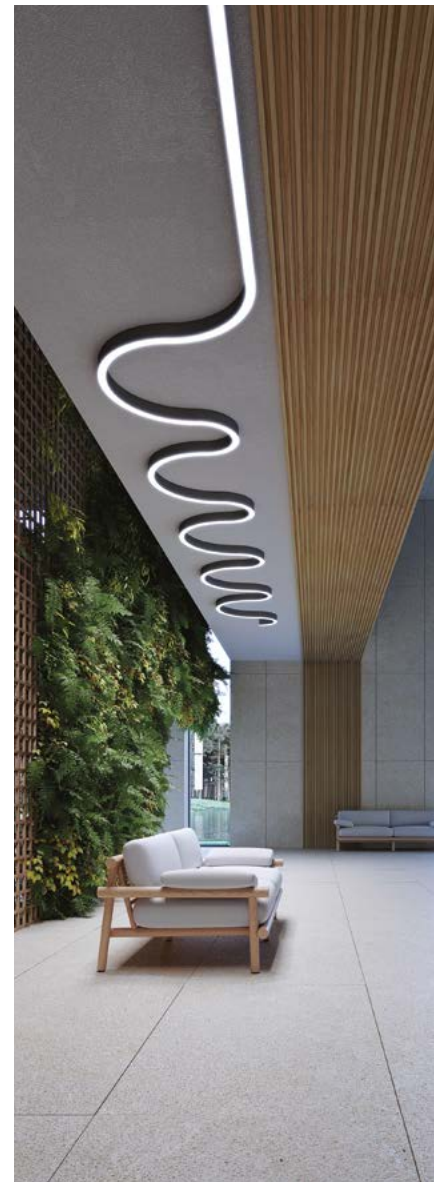

Premium aesthetics and finish

Available in a range of housing colours and elegant accessories.

Safety and durability

The luminaires are made from high quality aluminium, with all components meeting stringent safety standards.



The heart of every luminaire is its light source

Fixed-current LED modules, 220-240 V/AC, are the primary source of light.

They provide uniform distribution and high luminous efficacy, maintaining consistent light colour and minimal energy loss. For SERPENT-PLUS finished luminaires, efficacy can reach 135 lm/W. This translates directly into energy savings, lower operating costs and increased environmental responsibility in line with increasingly stringent building standards. Standard LED strips and zigzag bending strips are provided for the uplight version.

Digital LEDs are available on request. They enable individual light segments to be controlled, allowing advanced lighting scenarios, for example as shimmering colour uplighting.

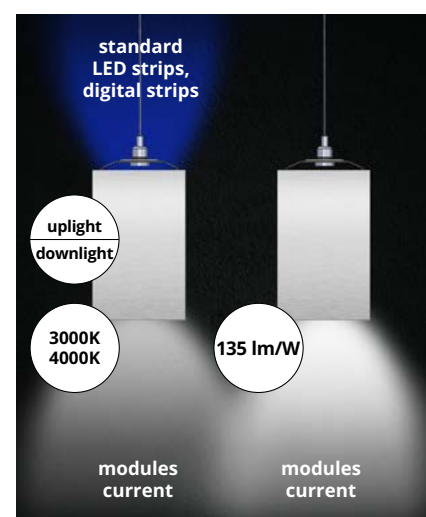



Light control matched to vision

The milk shield provides even dispersion ideal for general lighting, the micro-prismatic shield offers glare control with high efficiency. The DOT-45 lens allows the light to be precisely directed at angles of 20° or 48°.

This variety of optical options allows the creation of completely different atmospheres in a space using the same luminaire system.



Frosted cover



Microprismatic cover



DOT optics

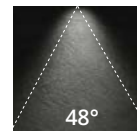
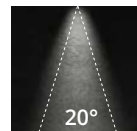

Light colour matters

SERPENT-PLUS luminaires are available in two light colours 3000K and 4000K.

3000 K (warm white) is the most popular LED colour, pleasing to the eye and creating a cosy atmosphere. It is a versatile choice for interiors where a warm but not overly yellow tone is desired. It works well in modern hotel rooms, lobbies or restaurants.

4000 K (Neutral white) is reminiscent of natural, comfortable daylight. It is ideal for offices and areas that require good visibility and concentration. It is also often chosen for modern, minimalist settings.



Ideal lighting workspace

Uplight / Downlight - delineating zones

The uplight / downlight function in a single luminaire opens up additional design possibilities, including multi-layered light compositions.

DALI control allows independent management of both sections, which in practice means the possibility of creating different lighting scenes, for example, adapted to the time of day.

In offices, this can be intense work lighting during the day and subtle backlighting during business meetings in the afternoon.



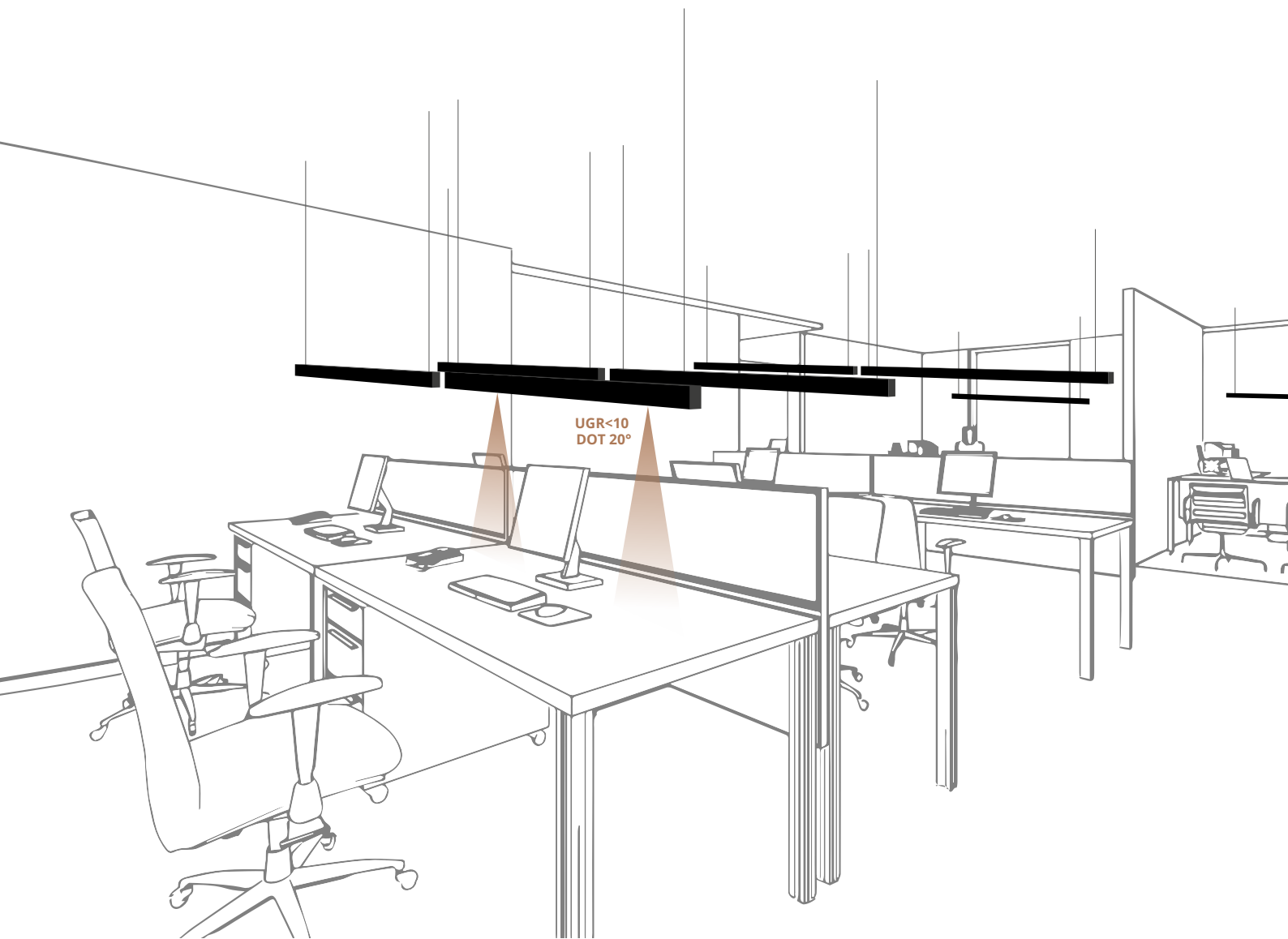

Low UGR glare index has a significant impact on reducing eye fatigue

Luminaires equipped with DOT optics with $UGR < 10$ (distribution angle of 20°) are ideal for precise illumination of workstations.

Luminaires with DOT optics and $UGR < 13$ (distribution angle of 48°) can effectively illuminate dedicated relaxation areas, creating a comfortable atmosphere in them.

On the other hand, luminaires with micro-prismatic shielding, characterized by $UGR < 19$, will be an ideal choice as general lighting, providing the high luminous efficiency needed to effectively brighten the entire room.

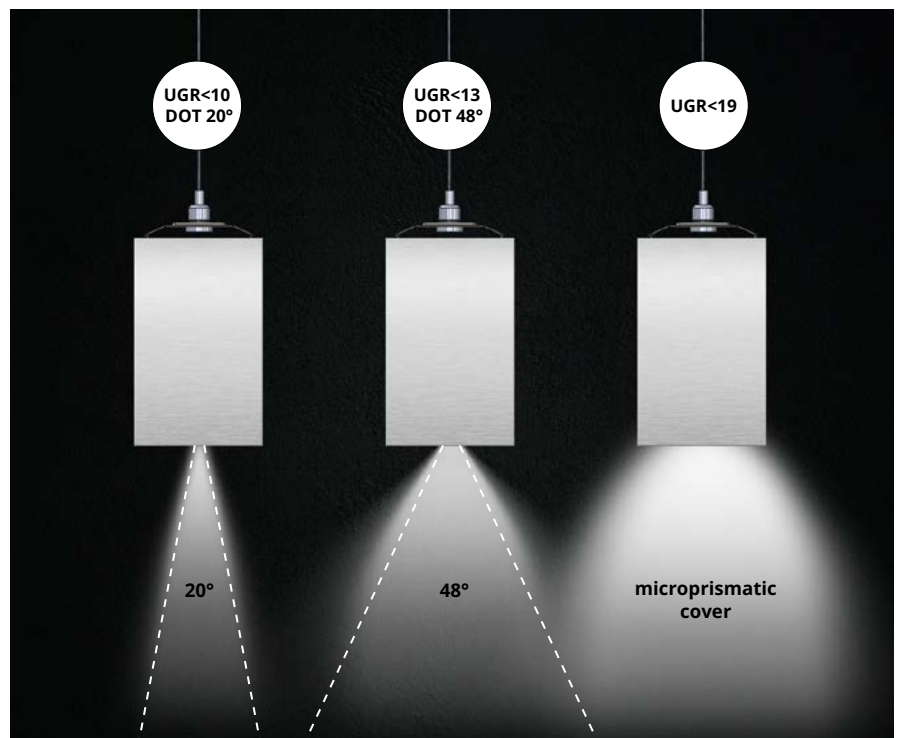

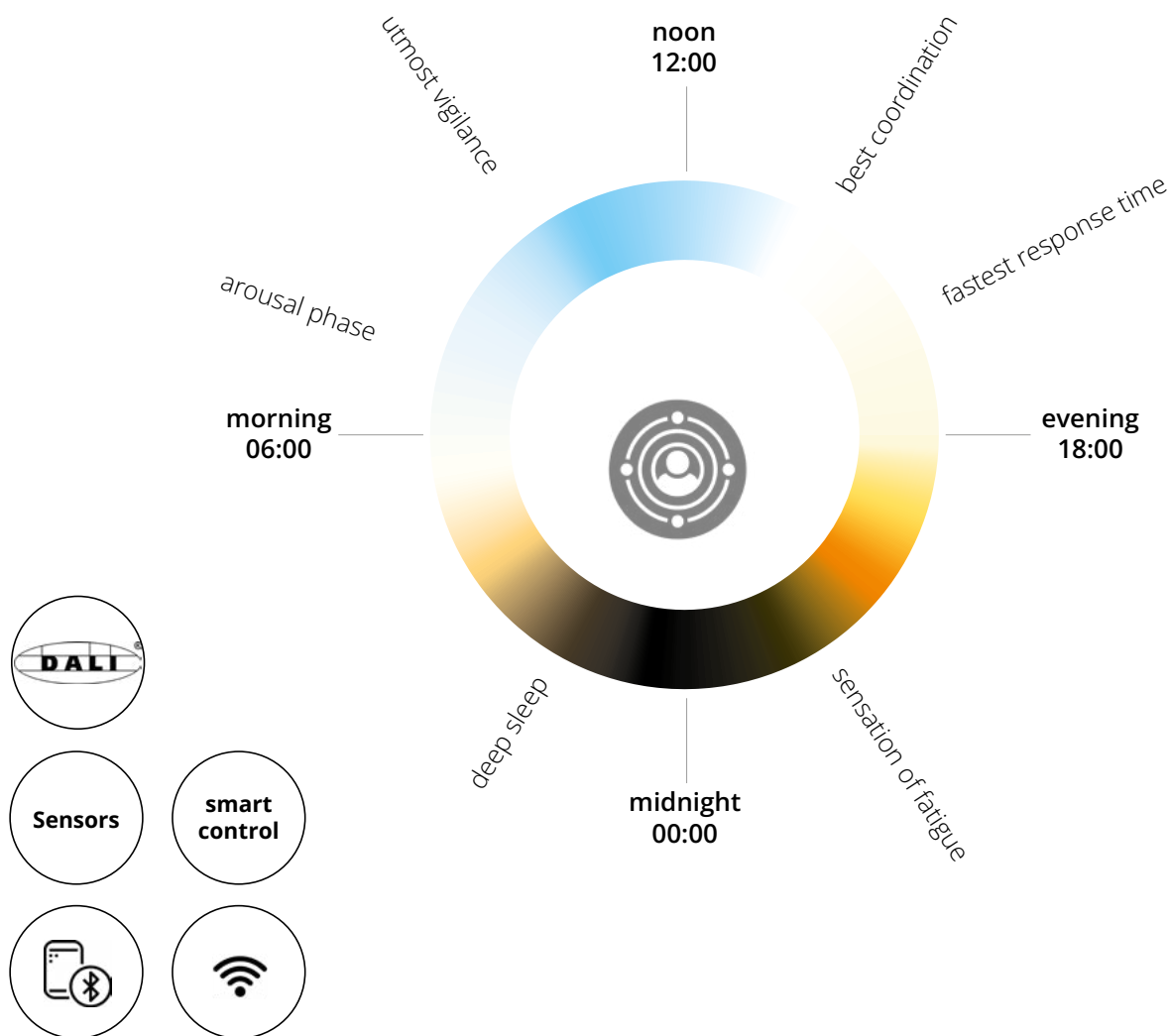

HCL concept - light that synchronizes you with nature

The Human Centric Lighting (HCL) concept focuses on people's needs and the impact of lighting on their well-being, productivity and health.

By simulating natural daylight, using biologically effective artificial light, people's internal clock can be influenced, stabilizing their diurnal rhythm. As a result, people can concentrate better, are more efficient, and the quality of their sleep improves.

Under HCL, light with a high blue content (temperature of at least 5300 K) is used from morning to noon and in the afternoon, as it has an activating effect and increases productivity. Toward evening, the color temperature becomes warmer (below 3000 K), which promotes relaxation. HCL's dynamic solutions adjust the brightness and color temperature of the lighting according to the natural course of daylight, moving from an activating cold white to a relaxing warm white.

SERPENT-PLUS with DALI control

Controlled via the DALI protocol, they allow precise control of color temperature and light intensity.

In offices, for example, it's adjusting lighting according to the time of day and activity, increasing comfort and concentration.

In schools, it's to create conditions conducive to learning, taking into account the natural diurnal cycle. In hospitals, it's improving patient well-being by simulating natural light.



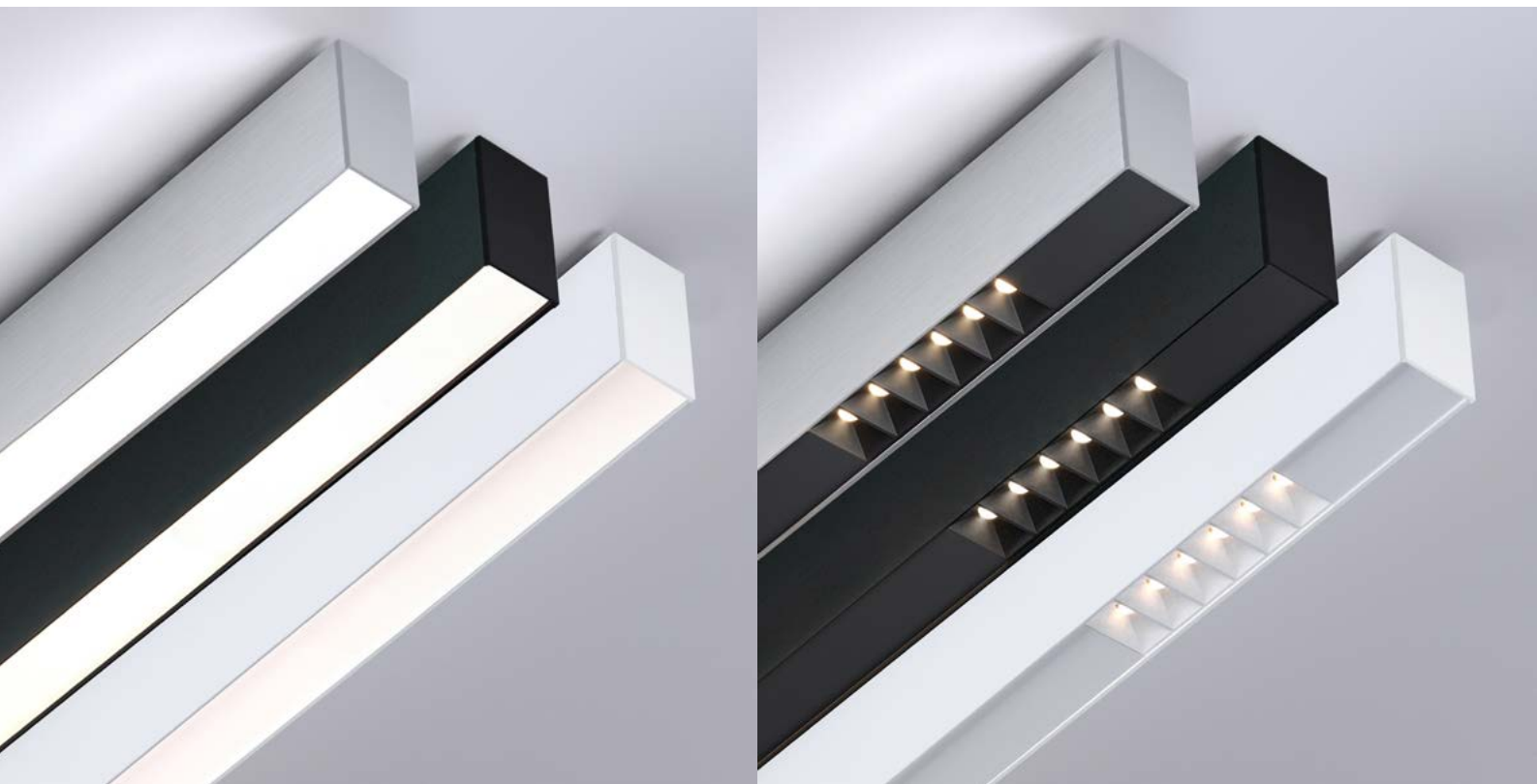

High-quality materials, quality of details

KLUS products are made of high-quality, double-anodized aluminum, and their painted versions feature perfectly color-matched elements.

Attention to detail, including elegant NHQ caps, dedicated headliners and color-matched fixtures, significantly increases the aesthetic value of the interior, reinforcing the impression of a refined lighting design. In addition, the offered covers can be tailored to specific needs.

Downlight covers

- frosted covers that diffuses light and meets the non-flammable standard
- prismatic covers with low glare coefficient $UGR < 10$

Uplight covers

- silicone frosted covers with high non-flammability rating
- clear covers for better light efficiency.





The power of universal colors,
The beauty of nature's colors

The standard finish palette includes black and silver anodizing and white lacquer, but 4 additional colors are available on request - caramel sand, pastel blue, light sage. The fixture can blend in perfectly with the architecture or become a distinctive accent, depending on the design intent.

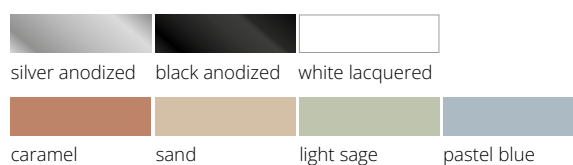

At KLUŚ, we believe in responsible
design and manufacturing



One of the first products to be made using special low-carbon aluminum. By using renewable energy sources, we reduce carbon emissions to less than a quarter of the global average for every kilogram of aluminum. As a result, we provide the raw material for luminaires with one of the lowest carbon footprints in the world. Minimizing the environmental impact of our products means maximizing the benefits for our customers.

Our suppliers provide Environmental Product Declarations (EPDs), demonstrating transparency and environmental care at every stage of our products' life cycle.



Installation simpler than you think

Suspended luminaire system

The suspended version includes a complete mounting kit including cables. In addition, you can find a range of accessories to support the installation, such as ZM connectors, cable covers, BOX-M70, BOX-M600, Fi-80 soffits, in three color versions, silver, black and white.

Uplight function

The silicone uplight cover is press-fit, which is intuitive and fast. Its specially designed shape makes it impossible to attach incorrectly. What's more, the silicone cover is available on a roll, allowing it to be easily cut to size and optimizing logistics and storage.

Surface-mounted luminaire system

SERPENT-PLUS surface-mounted luminaires are only available as downlights and are attached to the surface with fasteners (included).
For stabilization when connecting luminaires, use ZM connectors.

Magnetic bonding modules

Thanks to the use of an advanced magnetic connector system, each connection of two components is made quickly and intuitively, without interfering with the luminaire's internal structure.

This breakthrough system allows ready-made luminaires to be connected instantly, dramatically reducing the time required for installation.



Modular design: sections and curves

The system includes straight sections (length: 843 / 1123 / 1403 / 1683 / 1963 mm) and arcs, $\frac{1}{2}$ and $\frac{1}{4}$ circle (radius: R400 / R600 / R750 mm). All luminaires are available in two mounting versions: built-in and suspended.

Thoughtful configuration of modules allows flexible design of light lines, both straight and curved. This makes the system perfectly adaptable to the architectural and aesthetic requirements of various spaces.

Compatibility of modules

The two mounting systems can be combined to create compositions of suspended luminaires transitioning to a surface-mounted option.



Modularity and customization for your space

At KLUŚ, we understand how crucial it is to tailor lighting to the specific needs of the designed space. Our solutions offer not only modern design and high energy efficiency, but most importantly great customization possibilities.

For all customized solutions, please contact the Technical Advisory Department or the Sales Department.





Module-based customization

- **individual modules can be added, subtracted or exchanged for another variant**, e.g. a luminaire with more DOT optics, a white luminaire with black DOT optics, a luminaire with a microprismatic shield „interspersed” with blends, etc.
- **change of DOT optics arrangement**
- **additional colors: NCS** (lacquered whole luminaire including DOT, caps and blends), **RAL** (lacquered body only). In addition, you can mix color versions, e.g. white luminaire with caramel DOT, blends and blinds.

Changes in the length of straight luminaires, arches, covers, blends

- **custom length of straight luminaires**, taking into account fixed DOT dimensions
- **change in the length of the arc**, without changing the radius, taking into account the limitation of the length of the arc to 2700 mm, taking into account the fixed DOT dimensions
- **non-standard length of covers and blends**

Customization of components electronic

- **different type of LED for uplight version** - digital LEDs, current modules, RGB LEDs, RGBW, etc.
- **color temperature** in the range of 2700 - 7800K (clear white)
- **independent control for downlight and uplight**
- **additional control systems, switches**
- **power supply output location**

SERPENT-PLUS ZW

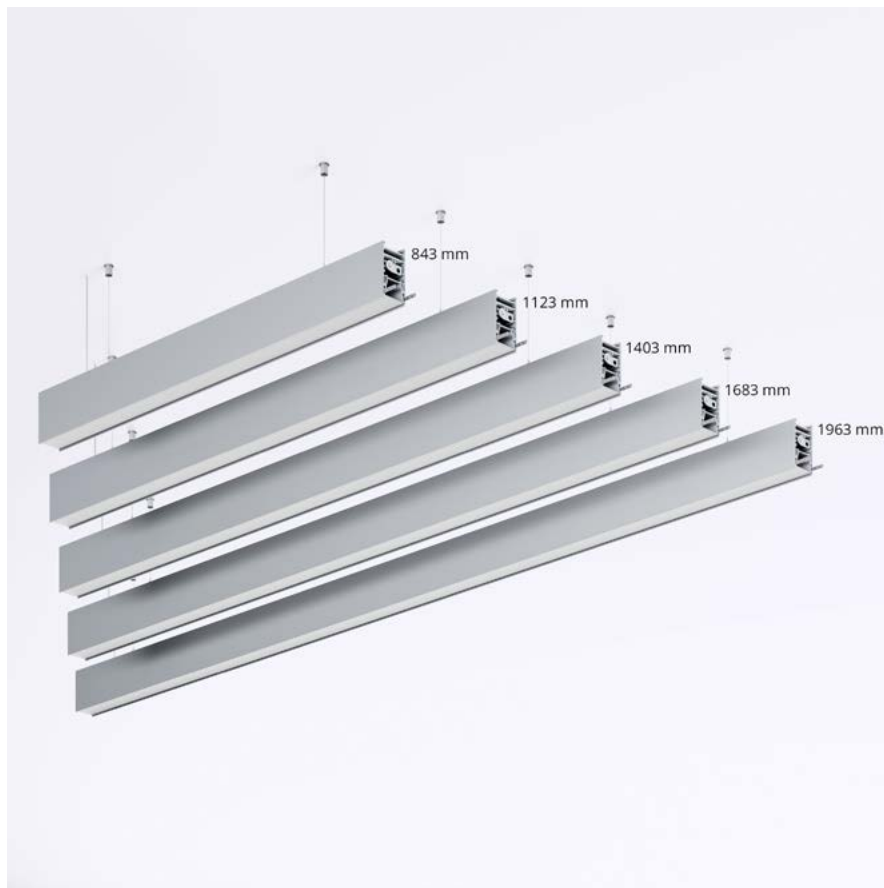

Linear, pendant luminaire

Material	aluminum
Available colors:	silver anodized, black anodized, white lacquer
Height [H]	88 mm
Width [W]	48 mm
Length [L]	843 mm, 1123 mm, 1403 mm, 1683 mm, 1963 mm
Degree of protection IP	20
LxBxY	L90B10
Service life	100000 h
Color rendering index CRI	90
Power supply	220-240 V 50/60 Hz
Protection class	I
Control	DALI ON/OFF
Color temperature	3000K 4000K

Luminous flux of the luminaire	2400 lm ÷ 7400 lm
Power of the luminaire	18 W ÷ 58 W
Light efficiency	120 lm/W ÷ 135 lm/W

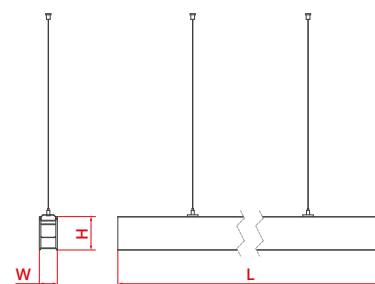

SERPENT-PLUS

SERPENT-PLUS DOT ZW

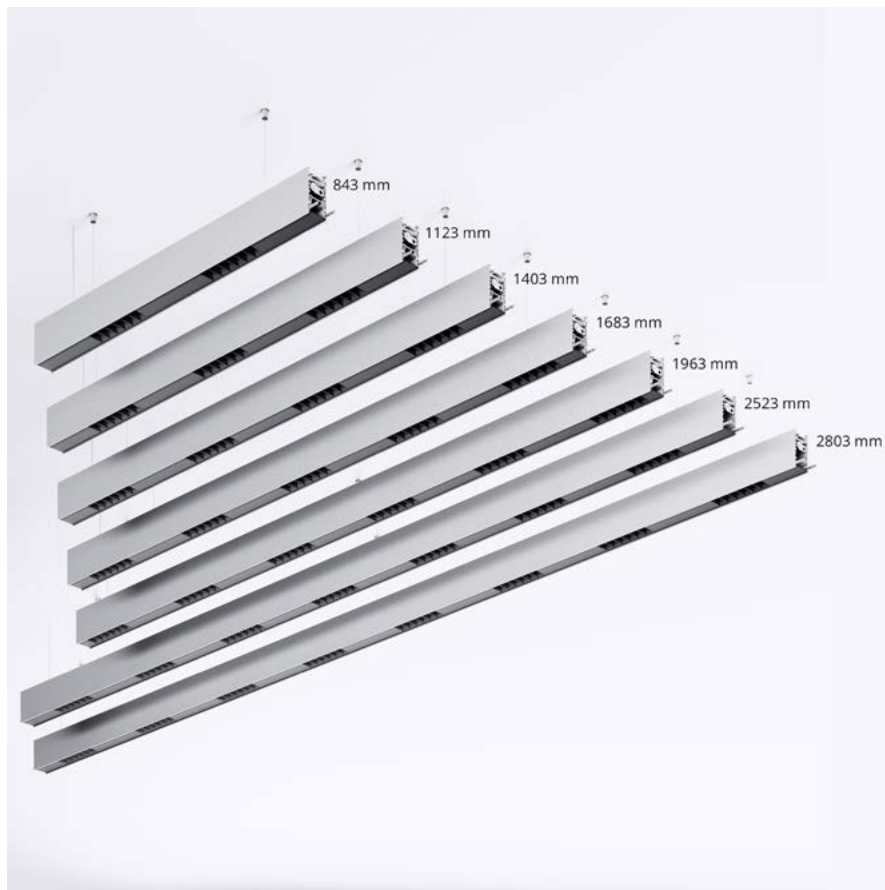

Linear, pendant luminaire

Material	aluminum
Available colors:	silver anodized, black anodized, white lacquer
Height [H]	88 mm
Width [W]	48 mm
Length [L]	843 mm, 1123 mm, 1403 mm, 1683 mm, 1963 mm, 2523 mm, 2803 mm
Degree of protection IP	20
LxBxH	L90B10
Service life	100000 h
Color rendering index CRI	90
Power supply	220-240 V 50/60 Hz
Protection class	I
Control	DALI
Color temperature	ON/OFF 3000K 4000K

Luminous flux of the luminaire	1100 lm ÷ 7150 lm
Power of the luminaire	12 W ÷ 70 W
Light efficiency	90 lm/W ÷ 104 lm/W

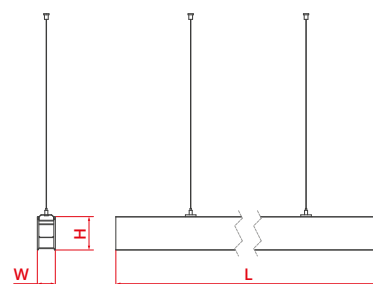

SERPENT-PLUS

SERPENT-PLUS NT

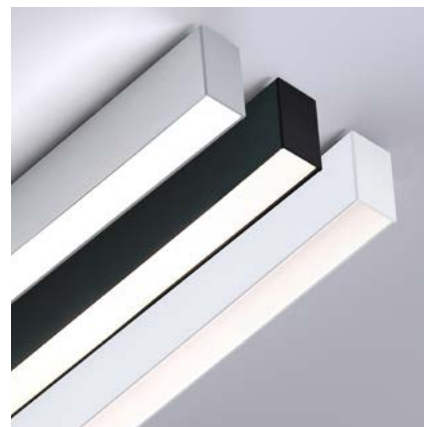
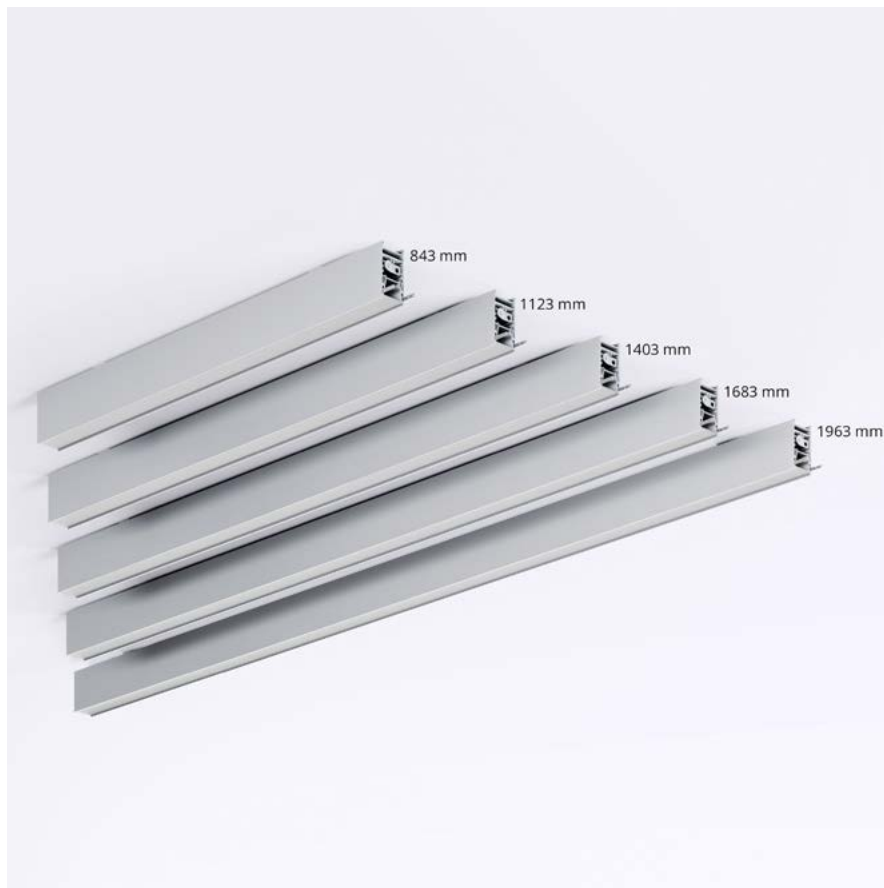

Linear, surface-mounted luminaire

Material	aluminum
Available colors:	silver anodized, black anodized, white lacquer
Height [H]	88 mm
Width [W]	48 mm
Length [L]	843 mm, 1123 mm, 1403 mm, 1683 mm, 1963 mm
Degree of protection IP	20
LxBxH	L90B10
Service life	100000 h
Color rendering index CRI	90
Power supply	220-240 V 50/60 Hz
Protection class	I
Control	DALI ON/OFF
Color temperature	3000K 4000K



Luminous flux of the luminaire	2400 lm ÷ 7400 lm
Power of the luminaire	18 W ÷ 58 W
Light efficiency	120 lm/W ÷ 135 lm/W



SERPENT-PLUS

SERPENT-PLUS DOT NT

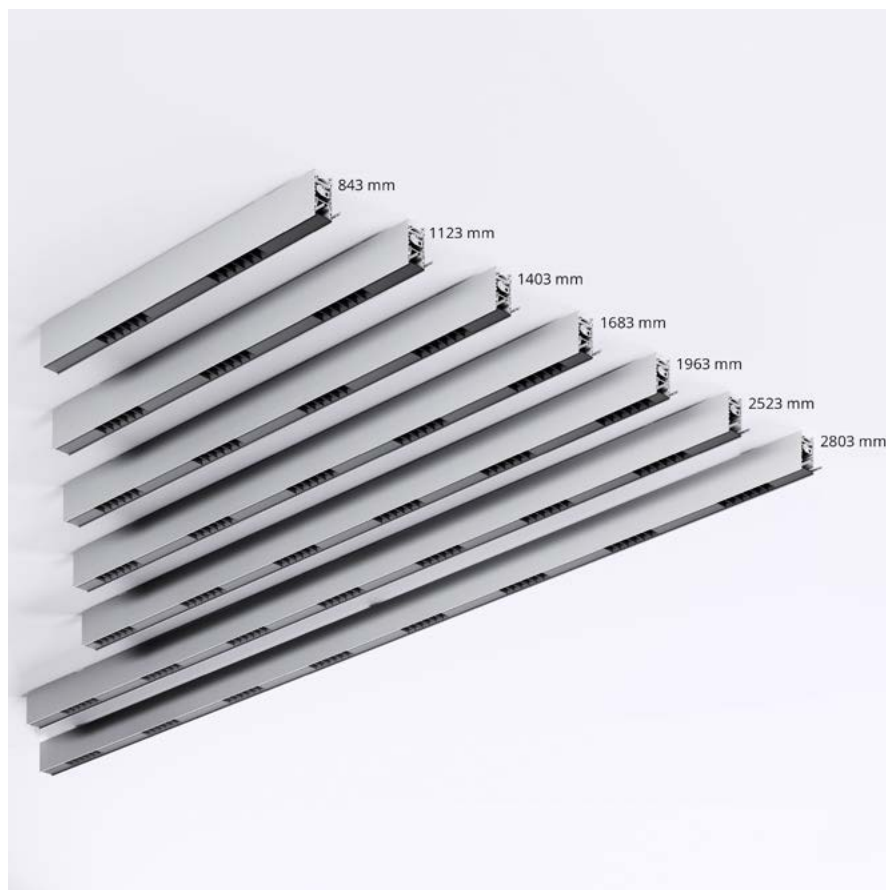

Linear, surface-mounted luminaire

Material	aluminum
Available colors:	silver anodized, black anodized, white lacquer
Height [H]	88 mm
Width [W]	48 mm
Length [L]	843 mm, 1123 mm, 1403 mm, 1683 mm, 1963 mm, 2523 mm, 2803 mm
Degree of protection IP	20
LxBxH	L90B10
Service life	100000 h
Color rendering index CRI	90
Power supply	220-240 V 50/60 Hz
Protection class	I
Control	DALI
Color temperature	ON/OFF 3000K 4000K



Luminous flux of the luminaire	1100 lm ÷ 7150 lm
Power of the luminaire	12 W ÷ 70 W
Light efficiency	90 lm/W ÷ 104 lm/W



SERPENT-PLUS

SERPENT R-PLUS ZW

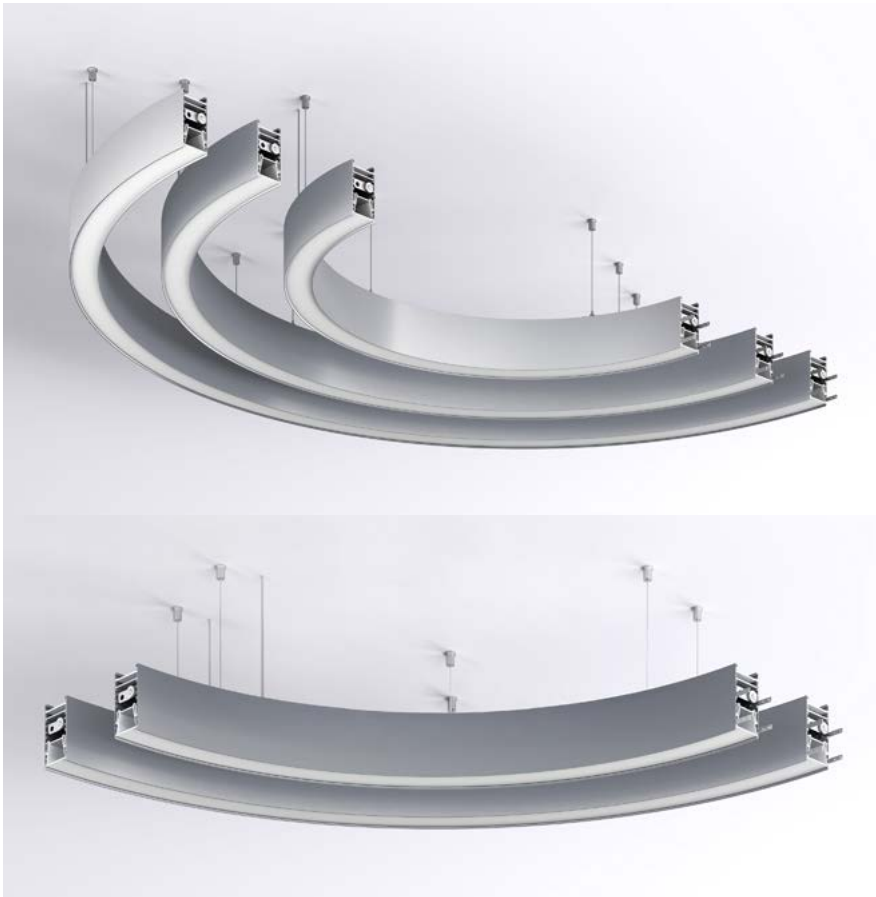

Linear, pendant luminaire

Material	aluminum
Available colors:	silver anodized, black anodized, white lacquer
Height [H]	88 mm
Width [W]	413 mm, 613 mm, 763 mm
Length [L]	R 1/2: 826 mm, 1226 mm, 1526 mm R 1/4: 413 mm, 613 mm, 763 mm
Degree of protection IP	20
LxBxH	L90B10
Service life	100000 h
Color rendering index CRI	90
Power supply	220-240 V 50/60 Hz
Protection class	I
Control	DALI ON/OFF
Color temperature	3000K 4000K

Luminous flux of the luminaire	2350 lm ÷ 7950 lm
Power of the luminaire	20 W ÷ 54 W
Light efficiency	107 lm/W ÷ 132 lm/W

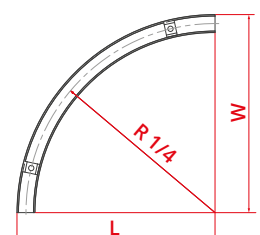
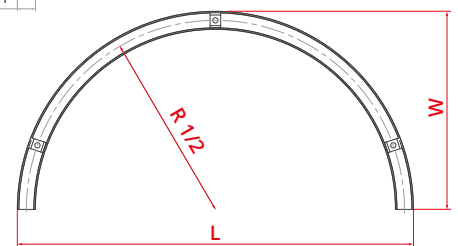
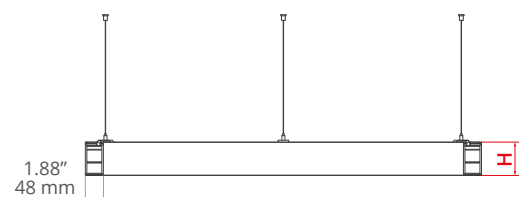

SERPENT-PLUS

SERPENT R-PLUS DOT ZW

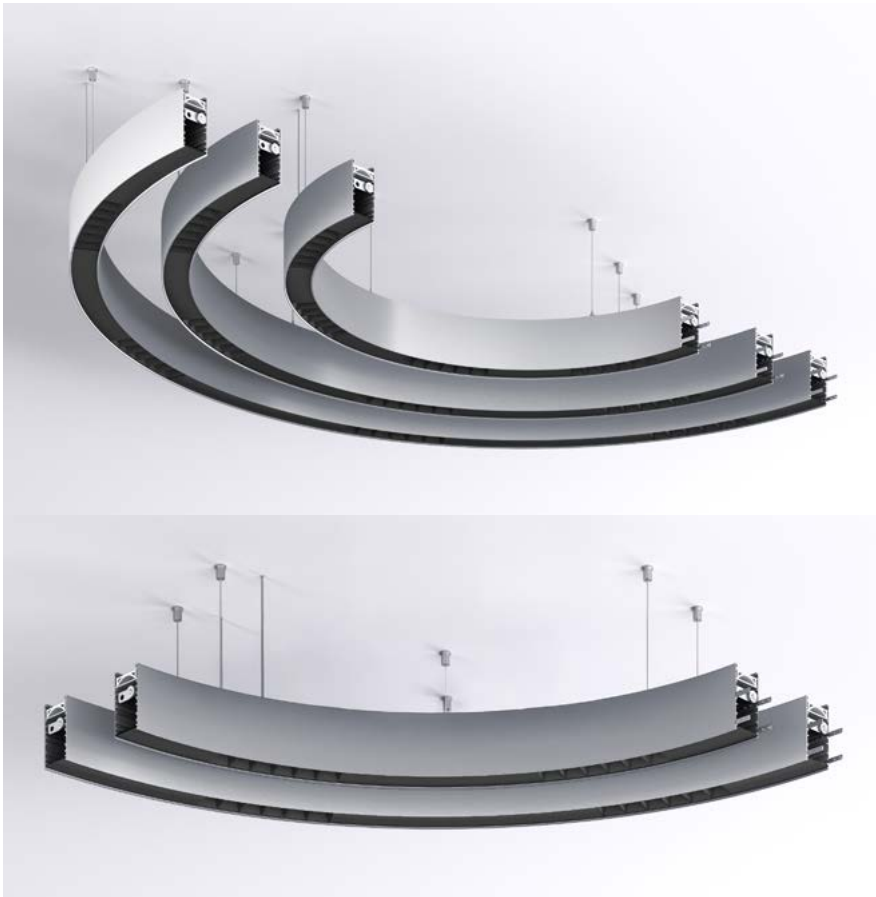

Linear, pendant luminaire

Material	aluminum
Available colors:	silver anodized, black anodized, white lacquer
Height [H]	88 mm
Width [W]	413 mm, 613 mm, 763 mm
Length [L]	R 1/2: 826 mm, 1226 mm, 1526 mm R 1/4: 413 mm, 613 mm, 763 mm
Degree of protection IP	20
LxBxH	L90B10
Service life	100000 h
Color rendering index CRI	90
Power supply	220-240 V 50/60 Hz
Protection class	I
Control	DALI ON/OFF
Color temperature	3000K 4000K

Luminous flux of the luminaire	1100 lm ÷ 4450 lm
Power of the luminaire	12 W ÷ 43 W
Light efficiency	83 lm/W ÷ 103 lm/W

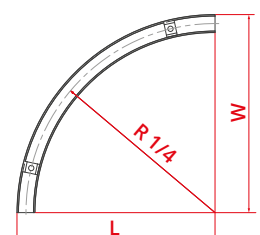
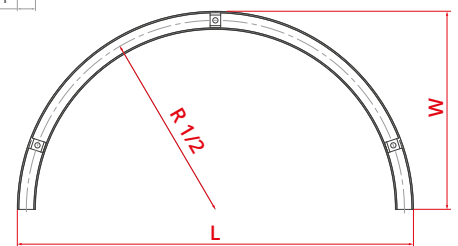
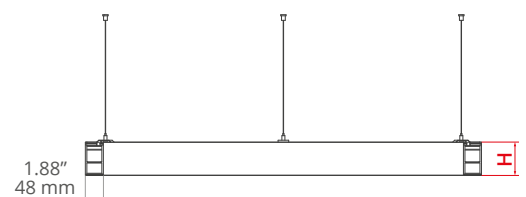

SERPENT-PLUS

SERPENT R-PLUS NT



Linear, surface-mounted luminaire

Material	aluminum
Available colors:	silver anodized, black anodized, white lacquer
Height [H]	88 mm
Width [W]	413 mm, 613 mm, 763 mm
Length [L]	R 1/2: 826 mm, 1226 mm, 1526 mm R 1/4: 413 mm, 613 mm, 763 mm
Degree of protection IP	20
LxBy	L90B10
Service life	100000 h
Color rendering index CRI	90
Power supply	220-240 V 50/60 Hz
Protection class	I
Control	DALI ON/OFF
Color temperature	3000K 4000K

Luminous flux of the luminaire	2350 lm ÷ 7950 lm
Power of the luminaire	20 W ÷ 54 W
Light efficiency	107 lm/W ÷ 132 lm/W

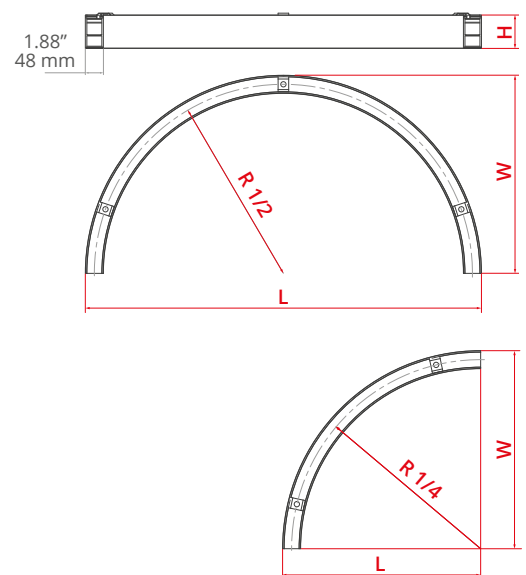

SERPENT-PLUS

SERPENT R-PLUS DOT NT



Linear, surface-mounted luminaire

Material	aluminum
Available colors:	silver anodized, black anodized, white lacquer
Height [H]	88 mm
Width [W]	413 mm, 613 mm, 763 mm
Length [L]	R 1/2: 826 mm, 1226 mm, 1526 mm R 1/4: 413 mm, 613 mm, 763 mm
Degree of protection IP	20
LxBy	L90B10
Service life	100000 h
Color rendering index CRI	90
Power supply	220-240 V 50/60 Hz
Protection class	I
Control	DALI ON/OFF
Color temperature	3000K 4000K

Luminous flux of the luminaire	1100 lm ÷ 4450 lm
Power of the luminaire	12 W ÷ 43 W
Light efficiency	83 lm/W ÷ 103 lm/W

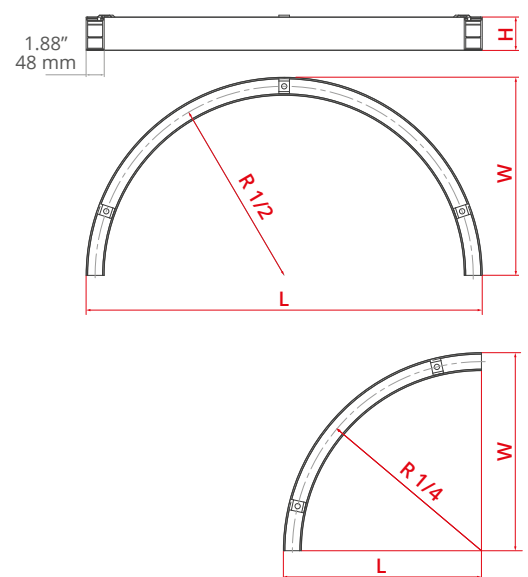

SERPENT-PLUS



KLUŚ Sp. z o.o.
Corporate Headquarter
Słoneczna 126 St,
05-506 Kolonia Lesznowola, Poland

www.KlusDesign.eu

Quotes

info@klus.pl

architects@klus.pl

Orders

orders@klus.pl

+48 22 757 40 51

KLUŚ products are proprietary and protected under U.S. and foreign patent laws.
We reserve the right to change and modify our products.

2025

